

T.1N.

HAMLIN

R.3W.

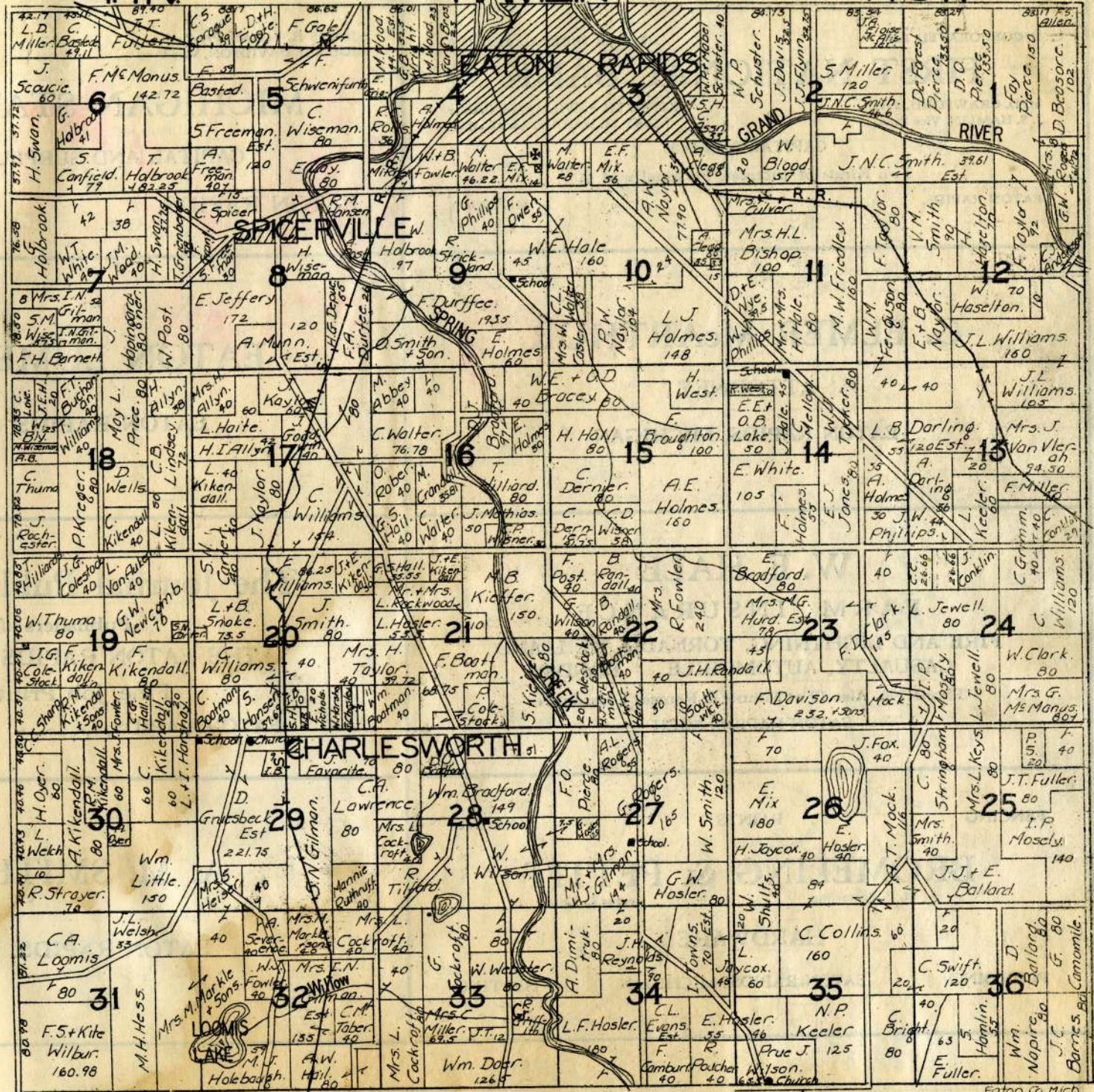

ducts

C
C
B
F
G
S
M
W
C
h

Six
easy dr
Ro
A li

A 50
The
at your

INCORPORATED 1877

MEMBER FEDERAL RESERVE

FIRST NATIONAL BANK

M. D. CRAWFORD, Pres.
J. S. HAMLIN, Vice Pres.

KENNETH P. WILLIAMS, Cashier
MARY M. HARRIS, Ass't Cashier

CAPITAL \$50,000.00

Two Kinds of Interest, Personal and 4%

EATON RAPIDS,

MICHIGAN

JAMES H. PARKS, Pres.
JOHN B. DAVIDSON, Vice Pres.

G. A. SPEERS, Cashier
CHAPPELL, Ass't Cashier

MICHIGAN STATE BANK

CAPITAL AND SURPLUS \$000.00

EATON RAPIDS,

MICHIGAN

G. ELMER McARTHUR

ATTORNEY

EATON RAPIDS, MICHIGAN

EATON LUMBER CO.

EATON RAPIDS, MICH.

W. E. HALE

FARM INSURANCE

FIRE AND LIGHTNING, TORNADO, HAIL AND
CASUALTY, AUTOMOBILE. BONDS

Phone 290, Also 19 at Minnie & Ramsey's Hardware

EATON RAPIDS, MICH.

The Journal Publishing Co.

Publishers of

THE EATON RAPIDS JOURNAL

—Fine Job Printing—

EATON RAPIDS, - - - - MICHIGAN

FENCING

PAINTS

ROOFING

BROMELING & PETTIT

M. P. Bromeling

George L. Pettit

HARDWARE

PLUMBING

EATON RAPIDS, MICHIGAN

HEATING

A. M. SMITH CO.

EATON RAPIDS, MICH.

G. A. SPEERS, Cashier
CHAPPELL, Ass't Cashier

BANK

000.00

MICHIGAN

CO.

G.

ing Co.

JOURNAL

g-
MICHIGAN

CO.

MICH.

T.2N.

EATON RAPIDS

R.3W.

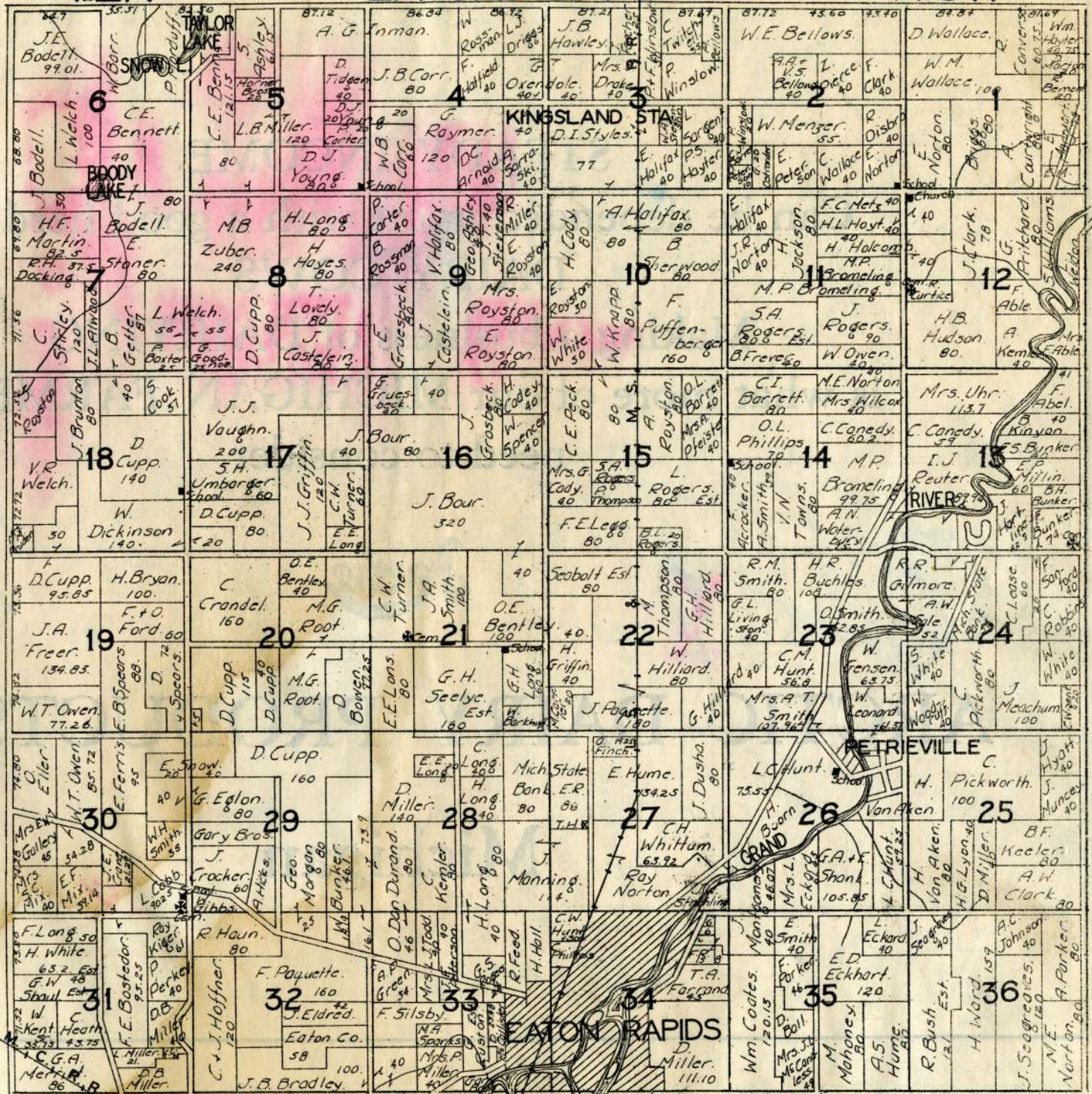

STEADY INCOME
Can be depended upon with a good herd of
DAIRY COWS
Making a business of **DAIRYING**
is what more of our **MICHIGAN FARMERS**
need to consider



ARCTIC DAIRY PRODUCTS CO.

Michigan

Handwritten numbers in blue ink:
41106
41126.36
6.63
57.23

Handwritten number in blue ink: 782

Handwritten number in red ink: 7.52

T.3N.

WINDSOR

R.3W.

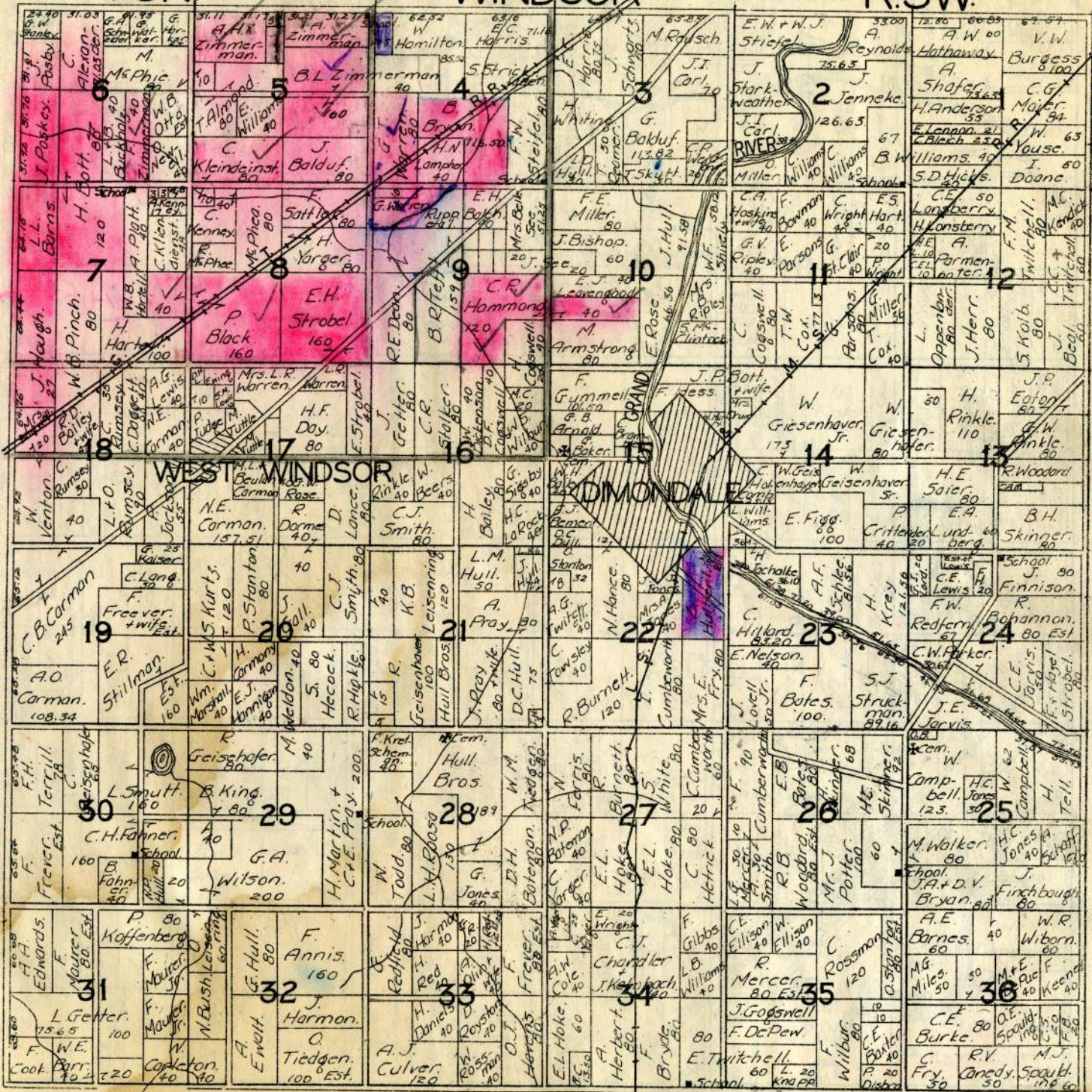

CO.

T.4N.

DELTA

R.3W.

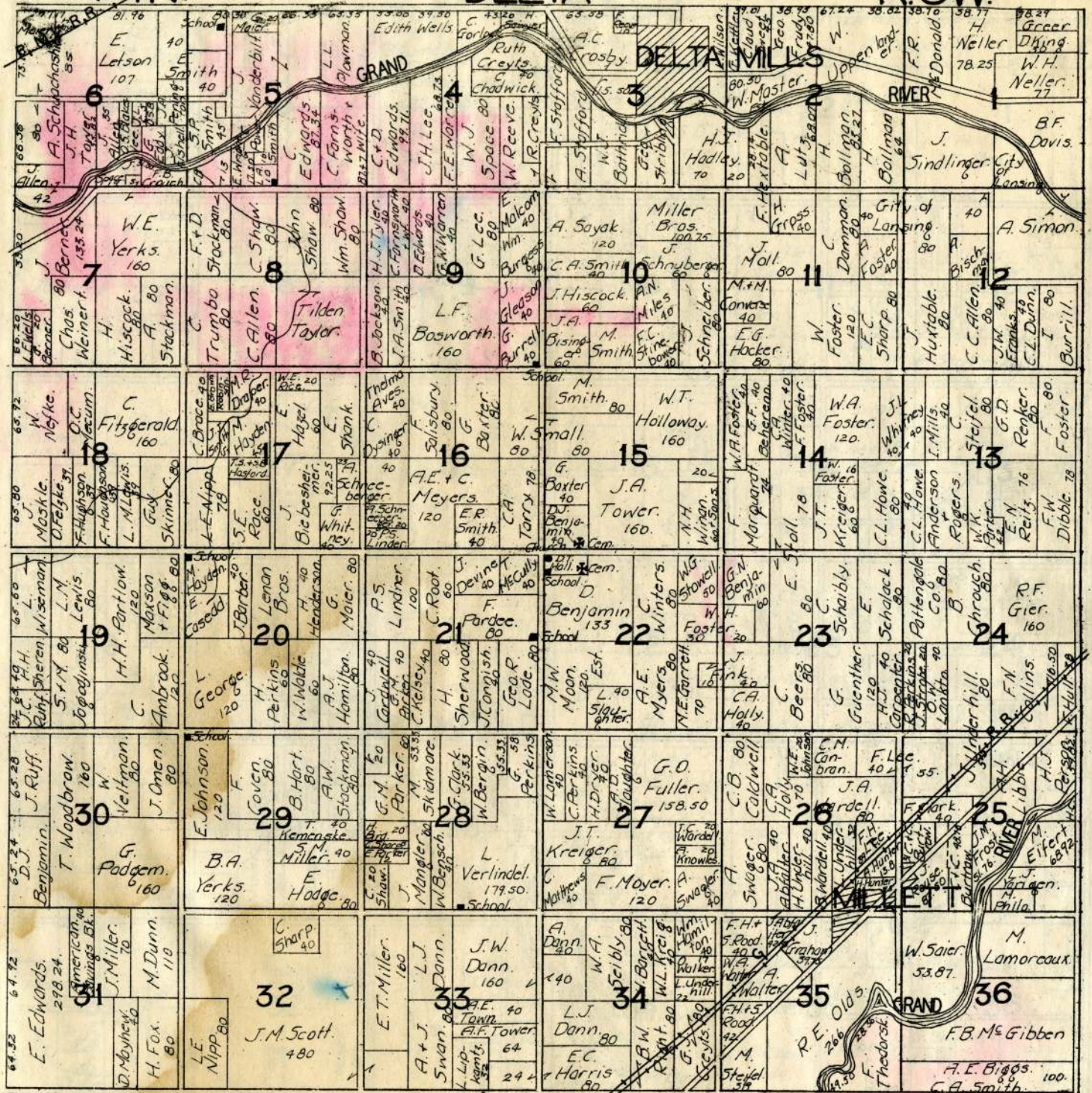

T. 1 N.

BROOKFIELD

R. 4 W.

<p>27.18 27.23 27.28 27.32 27.37</p> <p>S. Frank Frank Est</p> <p>6</p>	<p>27.32 27.37 27.42</p> <p>M.E. E. La Barr Spicer</p> <p>R. Shilts</p>	<p>27.42 27.47 27.52</p> <p>F. Spicer J.E. Parker</p> <p>5</p>	<p>27.52 27.57 28.02</p> <p>F. Spotts J.E. Parker</p>	<p>28.02 28.07 28.12</p> <p>O. Shumaker</p> <p>4</p>	<p>28.12 28.17 28.22</p> <p>F.N. O.M. Post</p> <p>3</p>	<p>28.22 28.27 28.32</p> <p>16.58 16.53</p> <p>C.D. Sederlund</p> <p>2</p>	<p>28.32 28.37 28.42</p> <p>46.41 46.47</p> <p>A. Colpaert</p> <p>1</p>	<p>28.42 28.47 28.52</p> <p>48.33 48.38</p> <p>N. Shoup N. Bridge</p>
<p>28.10 28.15 28.20</p> <p>E. Johnson</p> <p>7</p>	<p>28.15 28.20 28.25</p> <p>259.50 C. Mitchell</p> <p>8</p>	<p>28.25 28.30 28.35</p> <p>A. Nelson S.V. Phillips</p> <p>9</p>	<p>28.35 28.40 28.45</p> <p>I. Faulkner A. Stofflet</p> <p>10</p>	<p>28.45 28.50 28.55</p> <p>A. Stofflet</p>	<p>28.55 29.00 29.05</p> <p>G. Post A. Stofflet</p> <p>11</p>	<p>29.05 29.10 29.15</p> <p>G. Post A. Stofflet</p> <p>12</p>	<p>29.15 29.20 29.25</p> <p>J. Underkircher C. Steel</p>	<p>29.25 29.30 29.35</p> <p>J. Underkircher C. Steel</p>
<p>28.60 28.65 28.70</p> <p>W.H. Burnett</p> <p>18</p>	<p>28.65 28.70 28.75</p> <p>L. Parr</p> <p>17</p>	<p>28.75 28.80 28.85</p> <p>F. Parr H. Sherman</p>	<p>28.85 28.90 28.95</p> <p>C. Reeder C.V. Farry</p> <p>16</p>	<p>28.95 29.00 29.05</p> <p>C. Reeder M. Perry</p> <p>15</p>	<p>29.05 29.10 29.15</p> <p>G. Taylor R. Stevens</p> <p>14</p>	<p>29.15 29.20 29.25</p> <p>Dell Swan W. Nevills</p> <p>13</p>	<p>29.25 29.30 29.35</p> <p>C. Swan Ray Pinch</p>	<p>29.35 29.40 29.45</p> <p>J. Midling C. Thuma</p>
<p>29.12 29.17 29.22</p> <p>J.E. Sherman</p> <p>19</p>	<p>29.17 29.22 29.27</p> <p>G. McDonald H.C. Finward</p> <p>20</p>	<p>29.27 29.32 29.37</p> <p>H. Sherman M. Johnson</p>	<p>29.37 29.42 29.47</p> <p>H. Sherman A.G. Finch</p> <p>21</p>	<p>29.47 29.52 29.57</p> <p>H. Sherman F. Spicer</p>	<p>29.57 30.02 30.07</p> <p>T.J. Wells S. Wells</p> <p>22</p>	<p>30.07 30.12 30.17</p> <p>H. Logon F. Nevills</p> <p>23</p>	<p>30.17 30.22 30.27</p> <p>W. Mitchell T.T. Williams</p> <p>24</p>	<p>30.27 30.32 30.37</p> <p>W. Mitchell T.T. Williams</p>
<p>30.12 30.17 30.22</p> <p>J. Wrisley</p> <p>30</p>	<p>30.17 30.22 30.27</p> <p>H.H. Brown M. Sharp</p> <p>29</p>	<p>30.27 30.32 30.37</p> <p>N. Powers W.D. Poits</p>	<p>30.37 30.42 30.47</p> <p>N. Powers W.D. Poits</p> <p>28</p>	<p>30.47 30.52 30.57</p> <p>F. Spicer Tom Arsksey</p>	<p>30.57 31.02 31.07</p> <p>E. Ball G. Harris</p> <p>27</p>	<p>31.07 31.12 31.17</p> <p>J. Gilbart A. Rymore</p> <p>26</p>	<p>31.17 31.22 31.27</p> <p>A. Rymore M. Monetta</p> <p>25</p>	<p>31.27 31.32 31.37</p> <p>A. Rymore M. Monetta</p>
<p>31.12 31.17 31.22</p> <p>F. Zeider</p> <p>31</p>	<p>31.17 31.22 31.27</p> <p>C. Fordham J. Powers</p> <p>32</p>	<p>31.27 31.32 31.37</p> <p>N. Powers W.D. Poits</p>	<p>31.37 31.42 31.47</p> <p>N. Powers W.D. Poits</p>	<p>31.47 31.52 31.57</p> <p>A.G. Powell J.G. Estime</p> <p>33</p>	<p>31.57 32.02 32.07</p> <p>H. Wells S. Bly</p> <p>34</p>	<p>32.07 32.12 32.17</p> <p>H.H. Gilbart S. Bly</p> <p>35</p>	<p>32.17 32.22 32.27</p> <p>S. Bly J. Butler</p> <p>36</p>	<p>32.27 32.32 32.37</p> <p>S. Bly J. Butler</p>
<p>32.12 32.17 32.22</p> <p>F. Hisler</p> <p>31</p>	<p>32.17 32.22 32.27</p> <p>B. Peters W. Woodcock</p> <p>32</p>	<p>32.27 32.32 32.37</p> <p>N. Powers W.D. Poits</p>	<p>32.37 32.42 32.47</p> <p>N. Powers W.D. Poits</p>	<p>32.47 32.52 32.57</p> <p>W.H. Conant G. G. Estime</p> <p>33</p>	<p>32.57 33.02 33.07</p> <p>H. Wells S. Bly</p> <p>34</p>	<p>33.07 33.12 33.17</p> <p>H.H. Gilbart S. Bly</p> <p>35</p>	<p>33.17 33.22 33.27</p> <p>S. Bly J. Butler</p> <p>36</p>	<p>33.27 33.32 33.37</p> <p>S. Bly J. Butler</p>



T.2N.

EATON

R.4W.

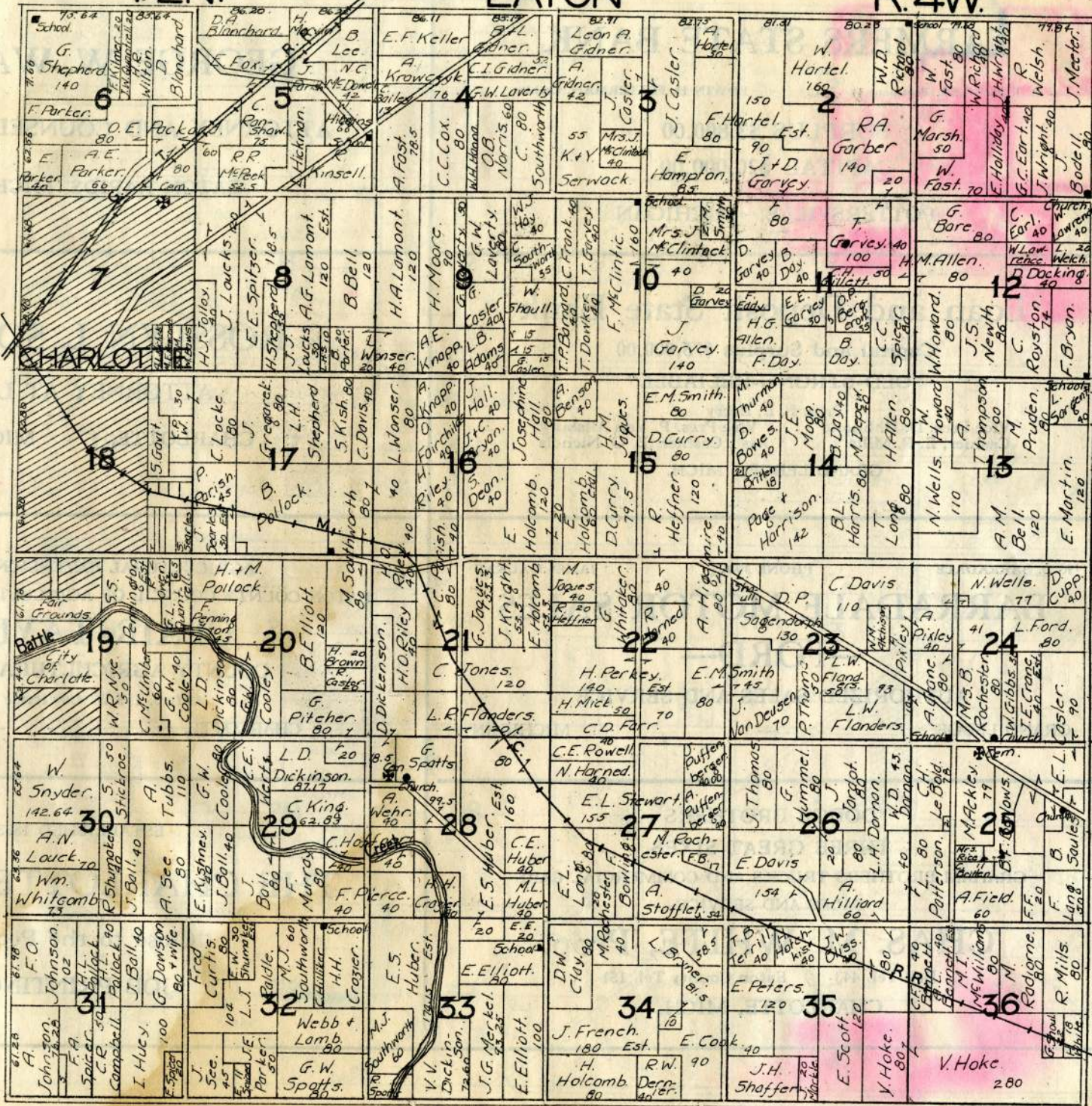

et Sales

IGAN

LL PHONE 180

ar Cars

COMPANY

n for the Study
ilk Products"

HIGAN

rst
e makings

S 63

umber Co.

HIGAN

R. S. SPENCER CO.

HARDWARE

CHARLOTTE, MICHIGAN

THE WINCHESTER STORE

BELDEN & COMPANY

INCORPORATED

CHARLOTTE, MICHIGAN

GRAIN - BEANS - COAL - FEED GRINDING AND
MIXING - GASOLINE - OIL - AUTOMOTIVE
SERVICE STATION

R. W. Carr Monumental Works

Mrs. R. W. Carr, Proprietor

MONUMENTS AND MARKERS

Charlotte, Michigan

The CHARLOTTE REPUBLICAN

ESTABLISHED 1854

CHARLOTTE, MICHIGAN

H. T. McGRATH, Publisher M. H. DeFOE, Editor E. M. McGRATH, Advertising Mgr.

Largest circulation of any paper in Eaton County



Fowler Chevrolet Sales

CHARLOTTE, MICHIGAN

CITIZENS PHONE 62

BELL PHONE 180

Service Sells Our Cars

THE DRY MILK COMPANY

"An International Institution for the Study
and Production of Pure Milk Products"

CHARLOTTE, MICHIGAN

Build a House First
We have the makings

BOTH PHONES 63

Shelden-Sanders Lumber Co.

CHARLOTTE, MICHIGAN

TSON

OR AT LAW

IGAN

WERS

AW

CHIGAN

N SERVICE

TURE AND RURAL LIFE

LOR

AL AGENT

ve.

MICHIGAN

LEADER

ople"

NG

T.3N.

BENTON

R.4W.

78.80 Wm Britten 120 F. Maggon	35.30 C. Rosier. H. Kraft. 120	30.20 Williams 70 J.N. McDaniel 50 E.M. Paine 70 C.A. Woodworth 120	38.88 Harold Woodworth 138.88	31.88 B.L. Backus H. Hohn 30 F. 67.22 Mulholland	38.69 A. Werner 138.60	62.74 J.L. Kelly 77.66 E. Smith 71.70	62.47 W.W. Cook 40 O.P. Wright 40	62.61 Lyron Bros. 115.6 W. Brown 80 W. Bensch 80 G. Fox 80 J.L. Wright 70	62.81 E. Griffin 157 W. Horston 90 J. Dorn 40 R. Decon 80 Winn Houston 160	62.76 A. Edwards 70.95
77.76 W. Parr 117.50 G. 37 1/2 Campbell	Wm. Casey 40 S. Ball 40	Frank. De Coe C.A. Woodworth 120 40 Geo	JA Walters 45 L.N. Chapelle 75 J.A. Walters 30 R.A. Porter 20	H.W. Burns. Rowden 80	Mulholland 70 Wm. Grove 40 Wm. Grove 40 John 30 John 40	Wm. Grove 40 Wm. Grove 40 Wm. Grove 40 Wm. Grove 40	I. Brown 80 W. Bensch 80 G. Fox 80 J.L. Wright 70	Hoston 80 D. Stange 40 W.F. 40 A. Cook 80	W. Horston 90 J. Dorn 40 R. Decon 80 Winn Houston 160	Winn Houston 160
77.52 C. Rosier. Wm. Shelling Boughters H. Lork 40 H. Lork 40 B.F. 36 J. J. 36 C. Polmentec L. Lipsey	F. Austin 80 H. Lork 40 H. Lork 40 B.F. 36 J. J. 36 C. Polmentec L. Lipsey	80 H. Woodworth 200 C. Haig 140 D. Horn 80	Rowden 80 Daniel Weaver 140 C.C. Weaver 70	H.W. Burns. Rowden 80 C.S. Churchill 100 Geo Squires 95 R. Marten 45	Mulholland 70 L.M. Churchill 90 R. Wichham 60 Mrs. J.G. Myers 100	Wm. Grove 40 Wm. Grove 40 John 30 John 40 Harry Latt Jr. 160	I. Brown 80 W. Bensch 80 G. Fox 80 J.L. Wright 70	Hoston 80 D. Stange 40 W.F. 40 A. Cook 80	W. Horston 90 J. Dorn 40 R. Decon 80 Winn Houston 160	Winn Houston 160
77.08 J.H. Forrell 120 S. Ball 40 A. Root 90	J.F. Lipsey 80 Rodgers 40 Goodrich 40 A.J. High 80 C. Haig 80	P.F. Casey 80 J.F. Lipsey 40 Leg. 40 Goodrich 40 Hazel Clay School	G.W. Spright 80 Burton 80 J. J. 40 J. J. 40 J.H. Davidson 80	A. High 40 T. Johnson 40 Weaver 80 School 46 G.W. Upright 80 E.D. Upright 80 Davidson 80 Jac Davidson 80 C.C. Weaver 120	Chas. Drake 120 James Davidson 80 Geo. 60 C. Crossland 80 Porter 60	R. Pinch 120 C. Van Orwick 80	A.F.+H.L. Green 120 E.N. Munger 40	A. Worth 40 H.W. Horn 40	R.R. Gaggg 20 F. Bachus 80 R.R. Gaggg 80 M.G. Jones 80	20 K F. Bachus 80 R.R. Gaggg 80 M.G. Jones 80
76.76 J. Kaesz 75 Joy Thompson 75	J. Kaesz 75 Joy Thompson 75 S.C. Goodrich 80 C. Haig 80	Ned. Lipsey 80 Jay Austin 100	R. Weaver 60 R. Upright 100	R. Upright 120 C.T. Upright 100	Von Camp 85 Soran Upright 80 Engle 80 P. Vandal 80 R. 80 Vance 80 H. Engle 80 Washburn 70 L.L. Varty 35 A. Nightengale 80 Ralph Leit 80	M. Fox 40 A.B. Winder 40 J. Lepien 80	H. Hartel 80	Wm. Feltzman 80 H.L. Hartel 80 D. V. Rinscy 138.50	M. Nishler 60.75	M. Nishler 60.75
76.03 H.H. Hayes 110.04 Albert Green 120 J.O. Kingman 80	H.H. Hayes 110.04 Albert Green 120 J.O. Kingman 80	W.Z. Mitchell 160 Church	E.P. Hough 120 A. 20 Walsh 20	Archie Walsh 160 School	R. J. Greer 152 P. Vandal 80 R. 80 Vance 80 H. Engle 80 Washburn 70 L.L. Varty 35 A. Nightengale 80 Ralph Leit 80	M. Fox 40 A.B. Winder 40 J. Lepien 80	H. Hartel 80	Wm. Feltzman 80 H.L. Hartel 80 D. V. Rinscy 138.50	M. Nishler 60.75	M. Nishler 60.75
76.20 L. Whelan 60 E. Whelan 90.20	L. Whelan 60 E. Whelan 90.20 Geo. Richardson 80 L.J. Colc. 100	B. Langers 50 W. Mitchell 80 V.A. Murray 50 J. Locke 80	R. Watts 60 John Powell 80 Myrtle McIntyre 100	W.R. Quantrell 80 E. 60 McIntyre 100	F. Van Vleck 160 A.E. Fox 120 W. 120 W. 120 E. 101 I. Gidner 101 Don Howkins 40 Nichols 80 C. Reed 80 O.C. Shance 160 Fohner 160	J. Gidner 101 Don Howkins 40 Nichols 80 C. Reed 80 O.C. Shance 160 Fohner 160	J.L. Marshall 520	G.F. Thomas 80 J.G. Gidner 80 M.D. Burkhead 80 D. Waters 80	G.F. Thomas 80 J.G. Gidner 80 M.D. Burkhead 80 D. Waters 80	
65.52 A.E. Whelan 90 Harrington 80 F.E. Scott 80 A.W. Holmes 80	A.E. Whelan 90 Harrington 80 F.E. Scott 80 A.W. Holmes 80	B. Langers 50 W. Mitchell 80 V.A. Murray 50 J. Locke 80	R. Watts 60 John Powell 80 Myrtle McIntyre 100	W.R. Quantrell 80 E. 60 McIntyre 100	F. Van Vleck 160 A.E. Fox 120 W. 120 W. 120 E. 101 I. Gidner 101 Don Howkins 40 Nichols 80 C. Reed 80 O.C. Shance 160 Fohner 160	J. Gidner 101 Don Howkins 40 Nichols 80 C. Reed 80 O.C. Shance 160 Fohner 160	J.L. Marshall 520	G.F. Thomas 80 J.G. Gidner 80 M.D. Burkhead 80 D. Waters 80	G.F. Thomas 80 J.G. Gidner 80 M.D. Burkhead 80 D. Waters 80	
64.88 J. Quantrell 90 L. Dadd 40 H.R. Wilson 40 L. Knop 40	J. Quantrell 90 L. Dadd 40 H.R. Wilson 40 L. Knop 40	School G. McConnell Roy 120 Lawrence 40	W. B. Otto 229	W. B. Otto 229	W. B. Otto 229	W. B. Otto 229	J.L. Marshall 520	G.F. Thomas 80 J.G. Gidner 80 M.D. Burkhead 80 D. Waters 80	G.F. Thomas 80 J.G. Gidner 80 M.D. Burkhead 80 D. Waters 80	
64.58 H.C. Richard 90 J. Quantrell 90 L. Dadd 40 H.R. Wilson 40 L. Knop 40	H.C. Richard 90 J. Quantrell 90 L. Dadd 40 H.R. Wilson 40 L. Knop 40	School G. McConnell Roy 120 Lawrence 40	W. B. Otto 229	W. B. Otto 229	W. B. Otto 229	W. B. Otto 229	J.L. Marshall 520	G.F. Thomas 80 J.G. Gidner 80 M.D. Burkhead 80 D. Waters 80	G.F. Thomas 80 J.G. Gidner 80 M.D. Burkhead 80 D. Waters 80	

POTTERVILLE

with

FARMERS STATE BANK

B. J. FOWLER, President

EDWIN H. FETTERMAN, Cashier

SURPLUS \$3,800.00

CAPITAL \$20,000.00

POTTERSVILLE, MICHIGAN

Loan and Deposit State Bank

Capital and Surplus \$75,000.00

"OLD-STRONG-RELIABLE"

Pres. F. L. Berry

Vice Pres. D. D. Shane

Cashier, E. P. Mills

Vice Pres. P. Van Allsburg

Ass't Cashier, F. G. Nichols

GRAND LEDGE, MICH.

R. B. BARRADALE

PHONE 39-A

JAMES MACKAY

BARRADALE MOTOR SALES

—FORD—

AUTHORIZED SALES AND SERVICE

GRAND LEDGE,

MICHIGAN

DODGE BROTHERS

THREE GREAT SIXES

GRAHAM BROTHERS TRUCKS AND COMMERCIAL CARS

SALES AND SERVICE

CHAS. M. WHITE, Prop.

Bell Tel. 443

Eaton County Tel. 151

CHARLOTTE, MICH.

GEORGE W. WATSON

ATTORNEY AND COUNSELOR AT LAW

EATON RAPIDS, MICHIGAN

ROSSLYN L. SOWERS

ATTORNEY AT LAW

CHARLOTTE, - MICHIGAN

AGRICULTURAL EXTENSION SERVICE

EATON COUNTY COUNCIL OF AGRICULTURE AND RURAL LIFE

CLAIR TAYLOR

COUNTY AGRICULTURAL AGENT

Office, 115 W. Lawrence Ave.

CHARLOTTE, - - - -

MICHIGAN

ESTABLISHED 1855

THE CHARLOTTE LEADER

"Close to the People"

JOB PRINTING

Office 808. Over 800

T.4N.

ONEIDA

R.4W.

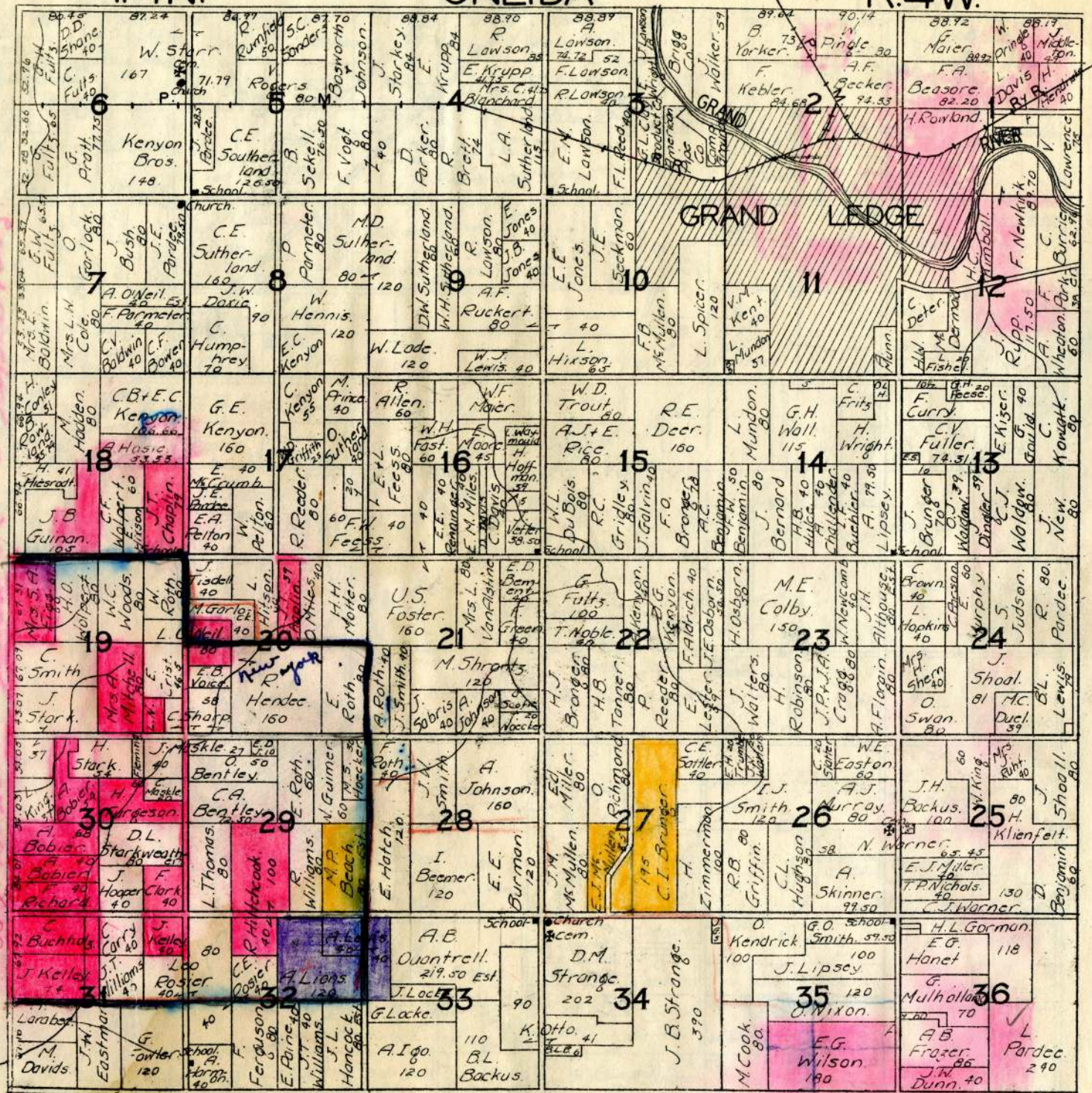

T.1N.

WALTON

R.5W.

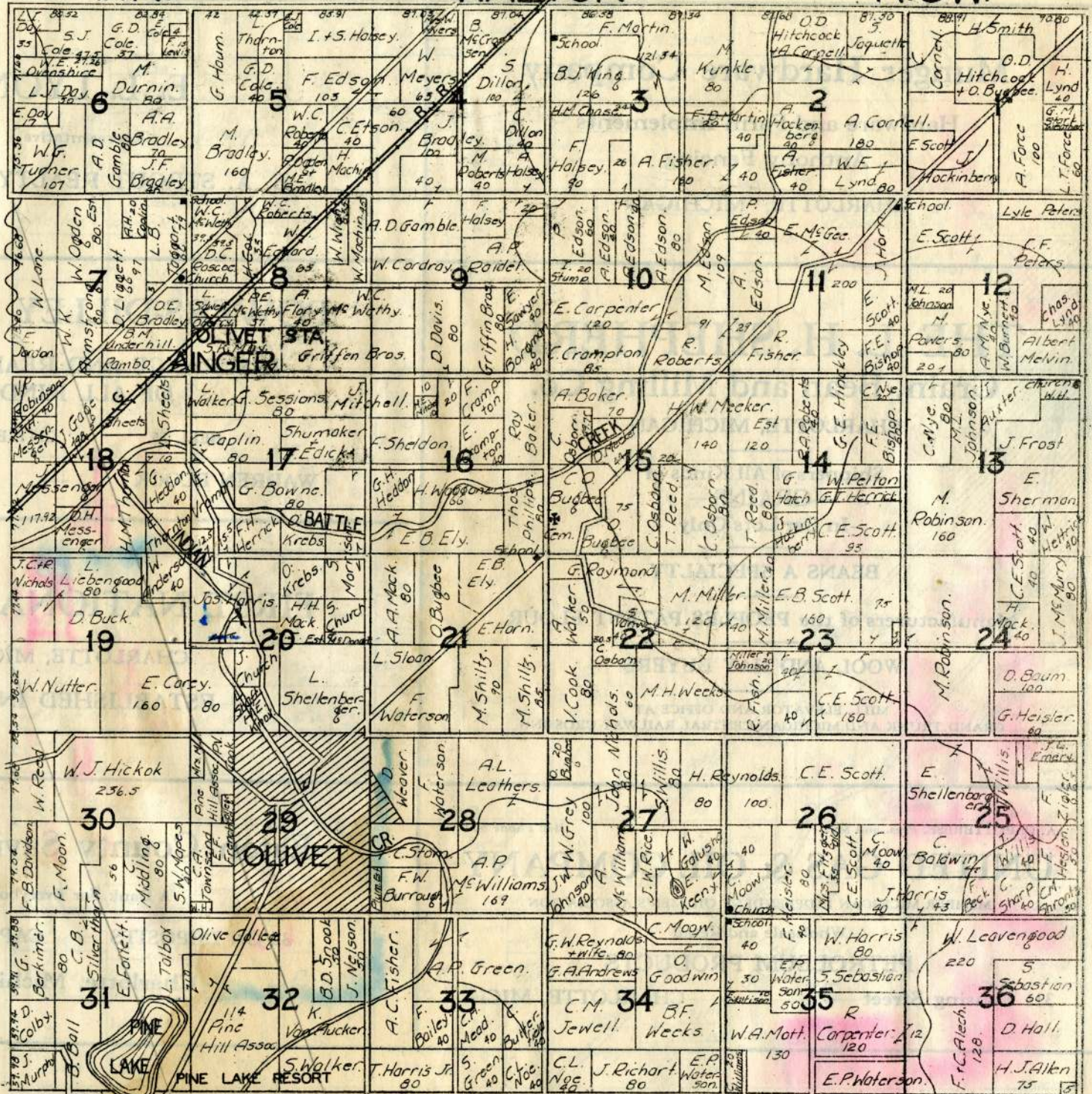

AGENCY

AGENCY

ESTATE

CHARLOTTE

BANK

Bank

000

N

Y AGENCY

AGENCY

AL ESTATE
DS

ZENS 277

CHARLOTTE

AL BANK

MICH.

IN 1870—

avings Bank

ybody

APITAL \$100,000

chigan

T.2N.

CARMEL

R.5W.

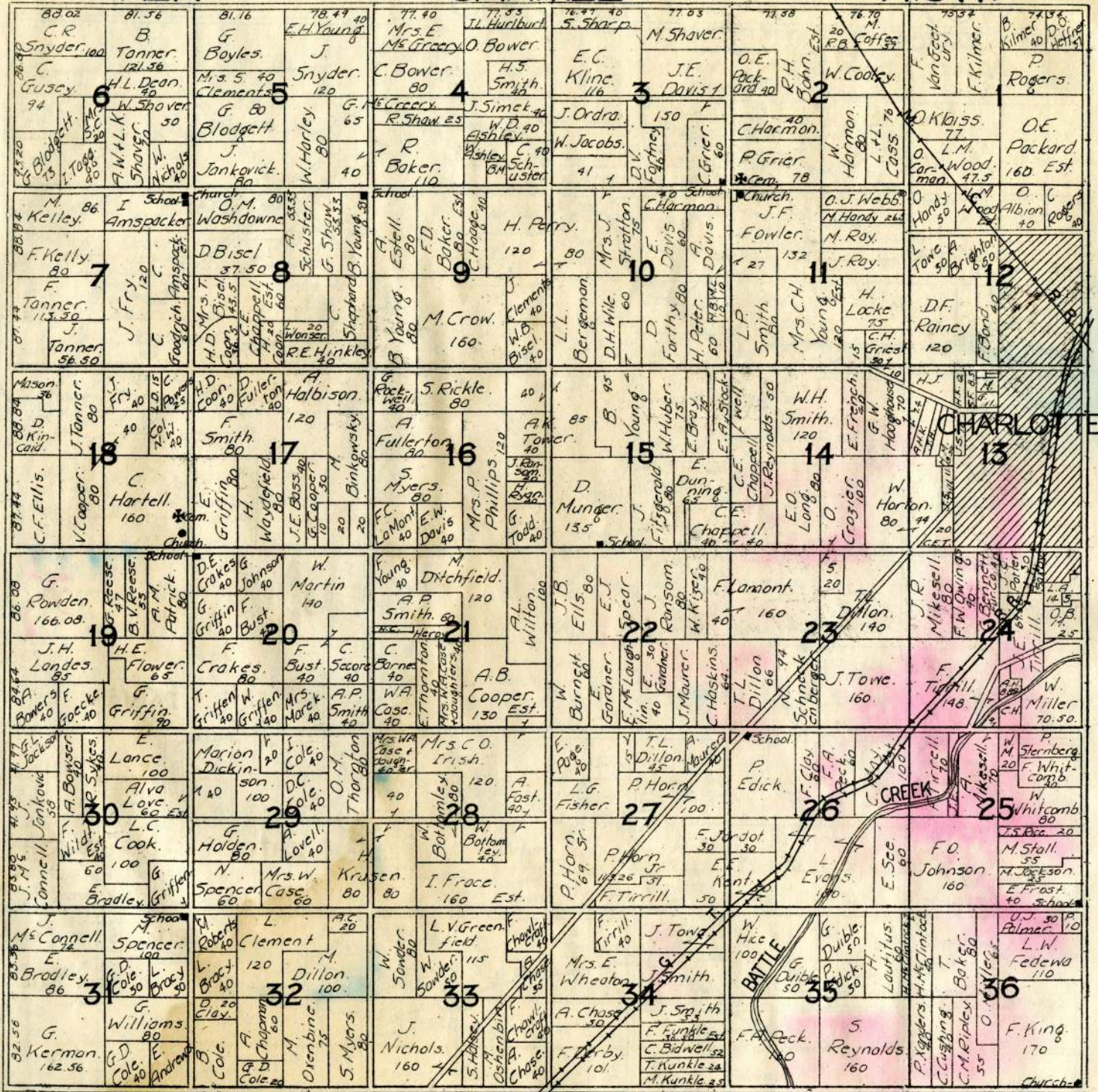

Munger Hardware Company

Hardware and Farm Implements

Anthony Fencing

CHARLOTTE, MICHIGAN

THE L. H. SHEPHERD Grain, Bean and Milling Co.

CHARLOTTE, MICHIGAN

Shippers of All Kinds of

—GRAINS—

In Car Lots Only

BEANS A SPECIALTY

Manufacturers of the PEOPLES PATENT FLOUR

WOOL AND HAY BUYERS

MILL, ELEVATOR AND OFFICE AT
GRAND TRUNK AND MICHIGAN CENTRAL RAILWAY CROSSING

A. C. PUTTBRESE, Pres. and Mgr.

Bell Phone 512

UNITED GAS & OIL COMPANY

MEMBER MICHIGAN INDEPENDENT OIL MEN'S ASSOCIATION

Wholesale and Retail

PETROLEUM PRODUCTS

311 Lansing Street

CHARLOTTE, MICH.

E. L. LYON

Representative

E. A. STROUT REALTY AGENCY

POWERS-DILLEY AGENCY

INSURANCE AND REAL ESTATE
OF ALL KINDS

BELL 75

CITIZENS 277

WARREN BLOCK

CHARLOTTE

FIRST NATIONAL BANK

CHARLOTTE, MICH.

—ESTABLISHED IN 1870—

Eaton County Savings Bank

A Bank For Everybody

3% ON DEPOSITS

CAPITAL \$100,000

Charlotte, Michigan

T.3N.

CHESTER

R.5W.

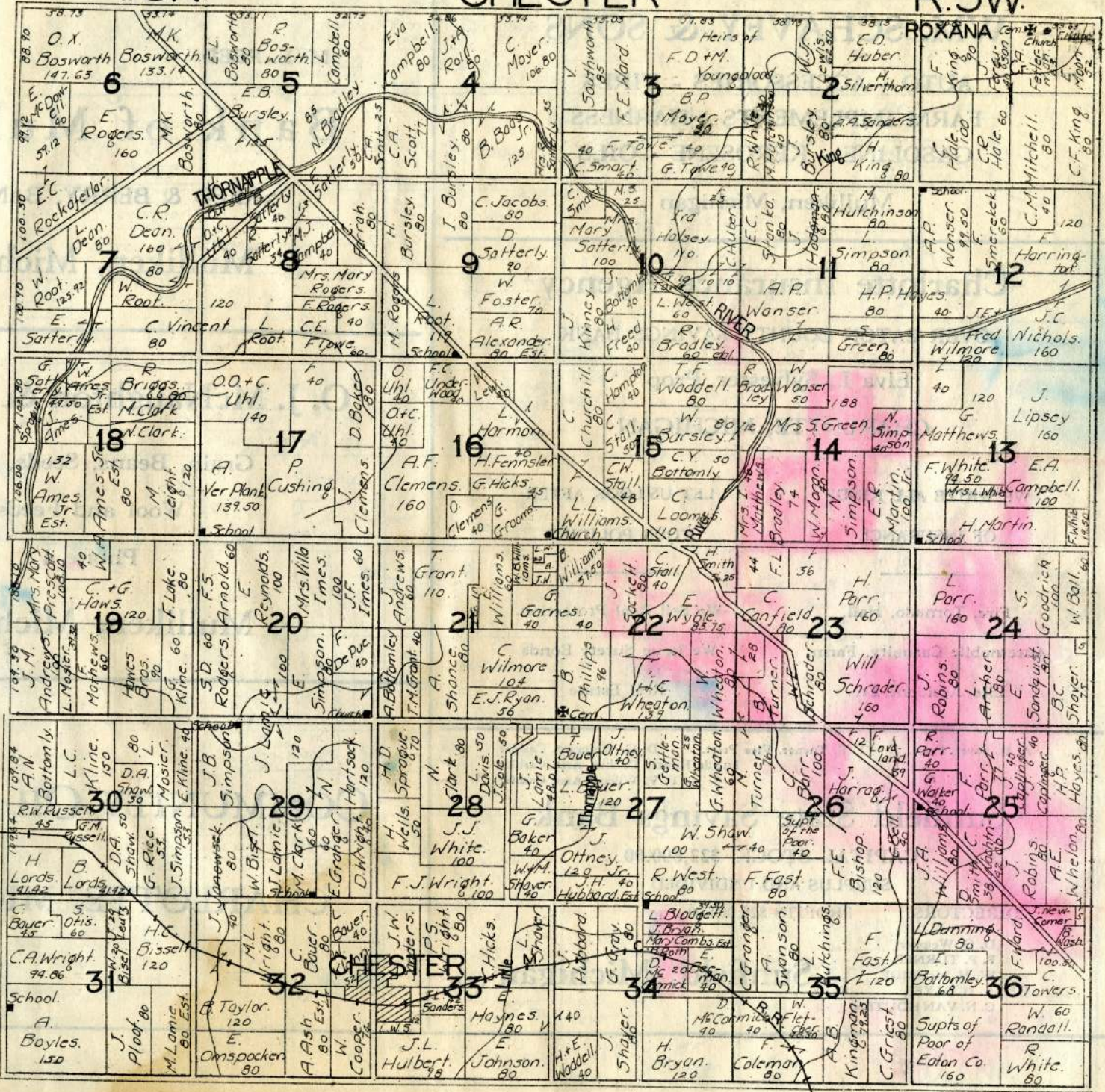

F. L. BERRY
 ulliken
 BANKERS
 Michigan
 & Company
 ds, Flour,
 eds
 Michigan
 IL CO., INC
 MICHIGAN

T.4N. ROXANA R.5W.

83.74 F. Sayer 80	43.44 J. Sayer 80	43.38 W. Sayer 80	43.01 Z. Cronkite 80	42.62 F. Feasal 80	81.97 W. Barber 80	40.64 E. Barnes 64	40.00 L. Triphagen 71	89.36 Van Nortwick 71	89.23 U.R.I. 71	88.74 W. Wilcox 110	88.89 A. Hart 102.17	88.45 M.D. Wallington 80	87.57 J. Moyer 167.57
87.08 N. Peabody 80	87.08 E. Dermid 80	87.08 R. Bascom 80	87.08 E.J. Peabody 154	87.08 G.K. Merrifield 159	87.08 H. Peabody 80	87.08 H. Peabody 80	87.08 H. Peabody 80	87.08 MULLIKEN 80	87.08 Lindner 150	87.08 C. Binns 80	87.08 R.C. Bell 40	87.08 Gates 60	87.08 J. Moyer 167.57
85.74 H. Berg 80	85.74 E. Worsor 80	85.74 R. Bascom 80	85.74 A. Griffin 120	85.74 J. Smith 40	85.74 W.D. Hill 80	85.74 H. Hill 80	85.74 D. Somrnie 104.50	85.74 A. Shigkel 80	85.74 Pierce 40	85.74 W. G. Pierce 80	85.74 W. Ames 80	85.74 R.I. Park 80	85.74 J. Moyer 167.57
85.74 J. Jack-son 50n	85.74 L. Randall 205.80	85.74 J. Sunken 80	85.74 C. Dille 40	85.74 O. Reed 80	85.74 P. Parker 80	85.74 C. Nesman 30	85.74 D. Somrnie 104.50	85.74 W. J. B. Nickel 80	85.74 Durham 50	85.74 W. G. Pierce 80	85.74 W. G. Pierce 80	85.74 W. G. Pierce 80	85.74 J. Moyer 167.57
86.26 H. Jackson 80	86.26 A. Jackson 80	86.26 L. Trowbridge 80	86.26 F. Lyon 80	86.26 A. Waldron 40	86.26 J. Parker 80	86.26 F.A. Whelpley 80	86.26 D. Hammond 80	86.26 P. Green 80	86.26 B. Taylor 120	86.26 M.D. Lynn 80	86.26 W. Kollman 150	86.26 W. Kollman 150	86.26 E. Bell 79
87.12 C.N. Vanhaulten 145	87.12 L. Campbell 80	87.12 S. Figg 80	87.12 O. Striker 80	87.12 R. Strong 80	87.12 J. Parker 80	87.12 F.A. Whelpley 80	87.12 I. Nashman 80	87.12 D. Parker 80	87.12 J. Hoscy 120	87.12 T. Ross 80	87.12 W. Kollman 150	87.12 W. Kollman 150	87.12 E. Bell 79
87.00 K. Dow 74.18	87.00 R.C. Bishop 89.18	87.00 H. A. Coc 80	87.00 F. Bacon 160	87.00 E.A. Collins 60	87.00 A. Furlong 100	87.00 C.W. Strong 80	87.00 H. Overholt 80	87.00 N. Hoscy 80	87.00 H.D. Burraoughs 200	87.00 P. Smith 80	87.00 H. D. Burraoughs 200	87.00 H. D. Burraoughs 200	87.00 H. D. Burraoughs 200
87.56 F. Jackson 80	87.56 A. Coc 80	87.56 J. Parker 80	87.56 F. Franks 80	87.56 R. Franks 80	87.56 G. Keefer 80	87.56 C. Ewing 80	87.56 W.M. Austin 80	87.56 J. Cole 80	87.56 E. Nebler 80	87.56 A. Boyer 80	87.56 C. Edgel 80	87.56 J. Skeoch 80	87.56 H. D. Burraoughs 200
88.13 B.J. Pumpfrey 80	88.13 L. Basworth 55	88.13 H. McIntire 120	88.13 D. Frizman 80	88.13 S. Parker 80	88.13 G. Keefer 80	88.13 O. Bosworth 100	88.13 G. Rimmel 100	88.13 J.D. Cole 80	88.13 J. Winters 80	88.13 J. D. Cole 80	88.13 J. Skeoch 80	88.13 J. Skeoch 80	88.13 H. D. Burraoughs 200
88.10 H. Miller 132.50	88.10 J. Holbrook 100	88.10 M. Miller 80	88.10 Huffman 80	88.10 J. Loucks 80	88.10 Litchfield 80	88.10 F. Root 80	88.10 G. Rimmel 100	88.10 J. Loucks 100	88.10 B. Harris 80	88.10 D. Mitchell 160	88.10 A. H. Carroll 80	88.10 J. M. Taylor 100	88.10 H. D. Burraoughs 200
88.18 Z. Granper 80	88.18 F. Pugh 80	88.18 F. Green 80	88.18 C. Boyer 80	88.18 J. Gaud 80	88.18 I. Hale 80	88.18 G. Root 120	88.18 G. Rimmel 100	88.18 A. Root 140	88.18 F. Root 80	88.18 C. King Bros 160	88.18 E.G. Lyon 80	88.18 C. Crist 80	88.18 V. O'Neil 160
88.18 N. Gunn 80	88.18 L. Gunn 80	88.18 A. Williams 80	88.18 J. Hale 160	88.18 H. Bedford 80	88.18 I. Hale 160	88.18 C. Moyer 80	88.18 W. Beekman 118.50	88.18 A. Root 140	88.18 King Bros 80	88.18 E.H. Rix 40	88.18 E.G. Lyon 80	88.18 C. Crist 80	88.18 V. O'Neil 160

Pats Mitchell
Petersey 160 A

WM. SCHAVEY & SONS

AUTO - ACCESSORIES - TIRES
FARM IMPLEMENTS - HARNESS
GASOLINE - KEROSENE - OILS

Mulliken, Michigan

Charlotte Insurance Agency

OVER EATON COUNTY SAVINGS BANK

Elva L. Sylvester, Prop.

CHARLOTTE, MICHIGAN

WE WRITE ALL KINDS
OF INSURANCE

LET US LOOK AFTER
YOUR POLICIES

Fire, Tornado, Hail,
Autcmobile Casualty, Farm,
Life, Accident, Etc.

We Sell Real Protection.
We Issue Surety Bonds
Real Estate

A. H. Sayer, Prest.

F. P. Turner, Vice Prest.

D. G. Weippert, Cashier

Lucille Hunter Ducker, Asst. Cashier

F. V. Wilcox, Asst. Cashier

Sunfield State Savings Bank

CAPITAL STOCK \$22,500.00

SURPLUS AND UNDIVIDED

DIRECTORS: PROFITS \$20,000.00

D. G. Weippert
F. P. TURNER
W. H. McBRIDE
A. H. SAYER
C. N. VANHOUTEN

Sunfield, Michigan

M. E. REED

F. L. BERRY

Bank of Mulliken

REED & BERRY, BANKERS

Mulliken, Michigan

O. J. McNaughton & Company

Grain, Beans, Seeds, Flour,
Wool and Feeds

Phone 4

Mulliken, Michigan

COMMUNITY OIL CO., INC.

CHARLOTTE, MICHIGAN

Farmers State Bank

Member Federal Reserve System

Bellevue, Michigan



Continuous Performance
Bellevue Lumber & Coal Co.

COMMERCIAL STATISTICS AND OTHER INFORMATION CONCERNING

BELLEVUE

BEAUTIFUL VIEW

Population - 1,200.

Location - Southwest corner of Eaton County, on the Grand Trunk Railroad, 13 miles from Charlotte (county seat) and 12 miles from Battle Creek. on state trunkline M - 78 direct to the state capital only 30 miles away.

Business Place - 43.

Banks - Two;

Deposits over \$700,000.

Schools - Excellent educational facilities are offered by a recently completed \$120,000 high school building. School is on the accredited list of the U. of M. School census, 400.

Churches - Three: Methodist Episcopal, Baptist and Roman Catholic.

Wholesale Outlets - Two elevators; one large grist mill located on the bank of the Battle Creek river. Large dam furnishes driving energy for mill.

Pavement - Over two miles of concrete paving within the corporation.

Parks - Two with fine accommodations for tourist camping

BELLEVUE WELCOMES YOU AND YOUR FRIENDS

E. F. MILLER F O R D

Sales and Service

BELLEVUE, MICHIGAN

Stevens Shoe Store

Good Shoes

Bellevue, Michigan

T.2N.

KALAMO

R.6W.

6 Nesman Muler 100 D.O. Barnes 50 A. Barker 115	5 Frank Reynard 120 Roy Haugh 120 D. 25 Hickey	4 W. Hunter 110 Scroll Power 120 C. Casler 115	3 P.B. Wells 120 H. Zemke 120 E. Tyler 40 W.S. Mudge 100 W. Wright 80 C. Gehman 100	2 C.H. Wells 160 I. Briggs 40 J.S. Tyler 100 B. Briggs 40 F. Bortg. 100	1 D. Briggs 100 Frank Vernon 40 80 5 Stuffer 80 L. Snook 40 F. House 100
7 Howard Mix 40 A. Nelson 100 W. Savage 100	8 Semor Hartwell 102 Ernest 100 Hartwell 98 J. Heath 100 Mason 40 Florence Shaw 100	9 Mix 40 J.W. Roach 60 H. Tye 100 Cecil Power 100 Martin Rohrig 80 H. Mason 100	10 Ernest Granger 150 F. Cass 100 J. Wilson 100 H.E. G.W. Davis 40 G. Gatt 100	11 State Bank 80 George Eilo 120 Tubbs 120 G. Picke 100 W. Link 100	12 Howard Boyd 100 C. W. Gehman 100 R.L. Dean 100 L. Biggs 100 Bert Briggs 40 N. Baker 40 Paul Perkins 60 F. Smunt 100
18 S.W. Curtis 129 Chas. Brown 129	17 J. Mason 100 W. 20 C. Baker Est. 100 Raffler 80	16 W.P. Kellogg 100 Southern 100 G.W. Cottrell 45 E.J. Morse 100 M.L. Brundige 100	15 Bert Sprague 100 Wm. Burck 40 George Frey 100 A.E. Dull 100 Minnie Slosson 120	14 John Frey 100 Don Smith 100 B.A. Nye 100 F. H. Nye 100 F. Paine 40 N. Robinson 100	13 Jesse Tuttle 100 C. Porter 100 Don Lewis 100 F. Sheppard 100 C.A. Cooper 100
19 W.C. Wilcox 100 Seroll Power 100 G. Shaul 60	20 F. Davis 100 Julia Taylor 100 L. Davis 80 Peter Klont 100 B. Mast 80 Van Aubshin 80 L. Curtis 160	21 Frank McWhinnie 100 L. Taylor 80 Wm. Douglas 100 E.H. Gridley 100 Wm. Fowler 100	22 Estell Babcock 160 A.J. Hawes 100 Tinkers Brothers 100 G. Sessions 100 A.P. Swift 100	23 W. Lawc. 100 R. Robinson 100 N. Robinson 100 C. P. King 100 W. J. Hall 100	24 C.A. Cooper 100 W. J. Hall 100 J.H. Landis 100 W. J. Hall 100
30 C.F. Norton 100 Milton 100 Wm. Cheeman 100 John Loomis 100	29 Tom Fuller 160 M.D. Rogers 100 Cecil Dye 100 Amos Dye 80 A. Shaffer 100 E. Pensc. 166	28 W.G. Martens 100 E.A. Keilan 100 J.E. Curtis 200 W.G. Martens 100	27 Stanol Earl 100 J. Curtis 100 W.S. Baird 100 A. Clem 100 Earl Crank 100 H. Wilson 100	26 F.J. Burkett 100 Edward Keck 100 P. Smith 120 W. Davidson 120	25 S.C. Sanders 100 J. Hall 100 Theron Bradley 80 W. J. Hall 100
31 John Loomis 100 Chas. Maps 100 W. Cunningham 240	32 E. Harry Gould 100 Bert Gould 100 L.G.S. Gould 100 Howard Oaster 100 W.H. Oaster 69	33 L. Bowler 100 Gaber Sears 100 C. Martens 100 E. Corroll 100	34 Earl Crank 100 H. Wilson 100 Roy Nabin 100 W. Johnson 100 Walter Merrifield 100 Clyde DeLong 100	35 O.W. Mad 125 W. Davidson 120 W. Johnson 100 A.L. Mikesell 120	36 Wm. Long 100 Theron Bradley 80 W. J. Hall 100 N.J. Brody 100 A. Day 100 N.E. Day 100

BARBER STATE BANK

Vermontville, Michigan

WEILERS GARAGE

CHEVROLET SALES

Vermontville, Michigan

Wilson Lumber & Coal Co.

Coal, Lumber, Cement, Lime, Roofing
and Building Material

VERMONTVILLE, MICHIGAN

BARBER BROTHERS

DEALERS IN

Dry Goods and Ladies' Ready-to-Wear,
Furnishings, Shoes and Work Clothing

"THE STORE OF SATISFACTION"

VERMONTVILLE, - - MICHIGAN

The Citizens Elevator Co.

Incorporated

Dealers in
GRAIN, BEANS, SEEDS, COAL, TILE,
FENCE AND POSTS

Vermontville, - - Michigan

CHAS. H. LAMB, Pres. J. S. GARINGER, Vice Pres. J. MILTON LENT, Cashier

The Citizens Bank

Unincorporated

Capital and Surplus \$23,000.00
Responsibility over \$300,000.00
We pay 4% on Savings Accounts

VERMONTVILLE, - - - - MICHIGAN

T.3N.

VERMONTVILLE

R.6W.

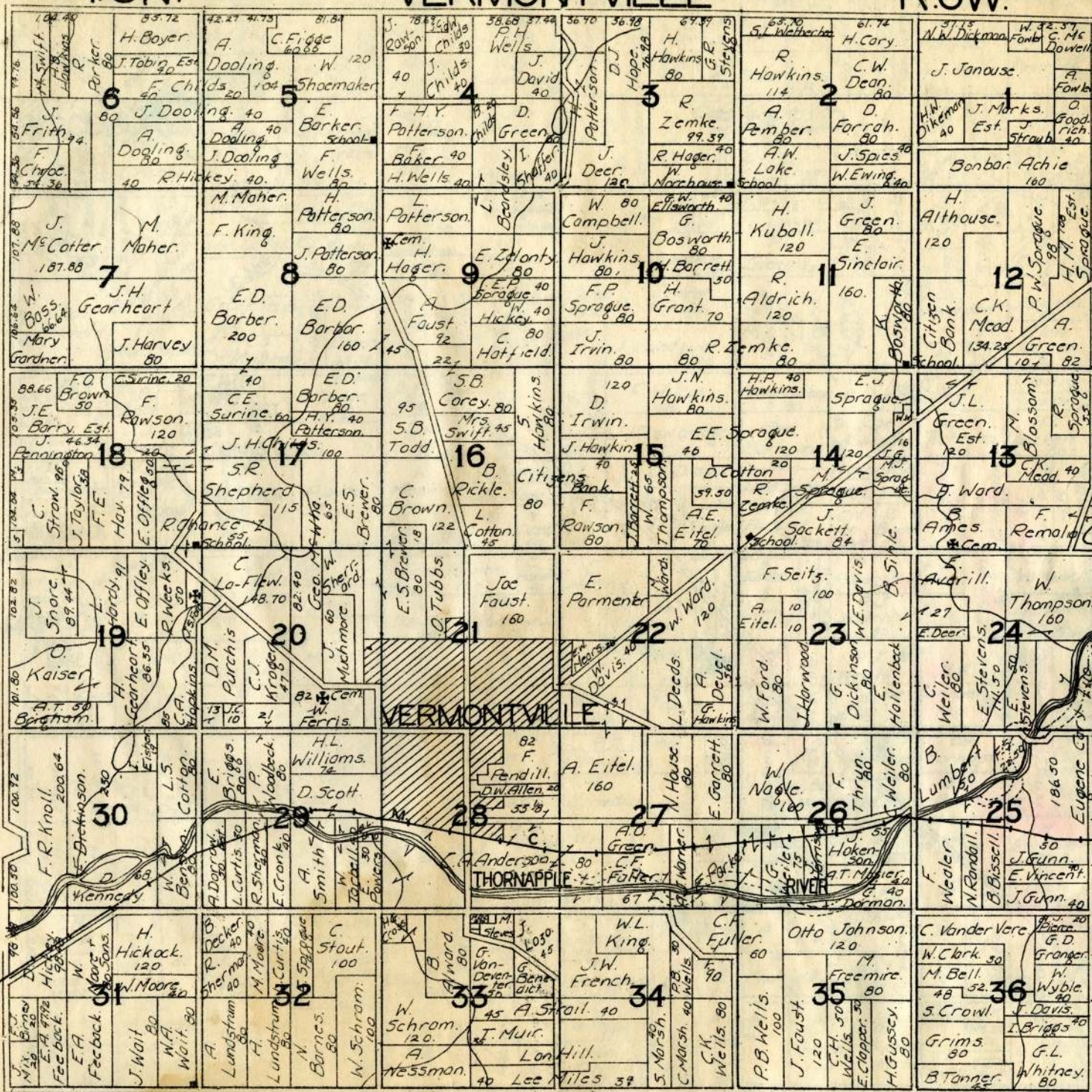

T.4N.

SUNFIELD

R.6W.

101.38 W. Shellborn	90.84 C. Leigh	90.04 O.S. Gray	89.12 H. Kinnel	88.24 Walter Childs	87.76 John Griffin	87.83 Andrew Boy	86.91 E. Honno	86.23 Verdo Ruffield	85.12 J. Curc
6 WOODBURY	5 O.S. Gray	40 Harlon Horn	40 Nancy Linhart	40 W.J. Hutchinson	20 Walter Childs	20 T.E. Shingcomb	20 T.E. Shingcomb	20 Chamberlin	20 Ficthorn
7 Chas. Eckhard	8 Wm. Lettles	9 J. Hoyer	10 Wm. Lettles	10 Wm. Lettles	10 Wm. Lettles	10 Wm. Lettles	10 Wm. Lettles	10 Wm. Lettles	10 Wm. Lettles
18 J.J. Rogers	17 R.E. Dodge	16 Dale Figg	16 H. Mesmore	16 H. Mesmore	16 H. Mesmore	16 H. Mesmore	16 H. Mesmore	16 H. Mesmore	16 H. Mesmore
19 B.D. Black	20 J.E. Hunter	21 R. Downs	21 E.L. Hunter	21 E.L. Hunter	21 E.L. Hunter	21 E.L. Hunter	21 E.L. Hunter	21 E.L. Hunter	21 E.L. Hunter
30 E. Plant	29 S. Walch	28 M. Hay	28 E. Colier	28 E. Colier	28 E. Colier	28 E. Colier	28 E. Colier	28 E. Colier	28 E. Colier
31 G. Hood	32 D.J. Fander	33 A. Dow	33 A. Dow	33 A. Dow	33 A. Dow	33 A. Dow	33 A. Dow	33 A. Dow	33 A. Dow
36 N.E. Fander	35 E. Green	34 H.A. Wells	34 H.A. Wells	34 H.A. Wells	34 H.A. Wells	34 H.A. Wells	34 H.A. Wells	34 H.A. Wells	34 H.A. Wells

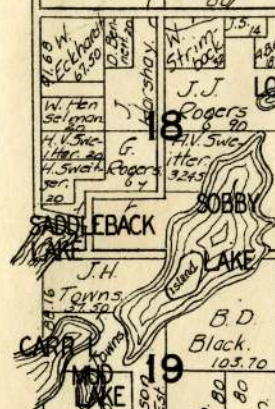

MATE FURNITURE COMPANY

"Where You Can Buy With Confidence"

R. HOWARD MATE, Proprietor

FURNITURE

CHARLOTTE,

MICHIGAN