

G
1413
.L6
R65
193-?

1000
PLAT BOOK OF
LIVINGSTON COUNTY, MICHIGAN

Published By
W. W. HIXSON & CO., Rockford, Illinois

Howell Co-operative Company

Farm Bureau Supplies

*Individual support of co-operative efforts
bring progress and savings*

Distributors of

Gas and Oil Supplies - Machinery
Feeds and Seeds-Coal

Phone Main 87

HOMER PEAVY

CALVIN PEAVY

H. W. & C. A. PEAVY

Coal - Builders Supplies - Feed

Phone 184-W

HOWELL, MICH.

MAP LIBRARY
ROOM USE ONLY

4
1413
26
1931

Refrigerated Food Locker Service

The safest and most economical storage for meats, fruits and vegetables.

READY TO COOK AND SERVE
COMPLETE BUTCHERING SERVICE

Phone 252 F 3

FOWLerville, MICH.

PHONE 50

LIST WITH

W. L. BIDWELL

Real Estate-Farms a Specialty

232 3rd Street

BRIGHTON, MICH.

The Vogt Funeral Home

Over a quarter century of service at a price within the reach of all.

AMBULANCE SERVICE

PHONE 252 F 2

FOWLerville, MICH.

LIBRARY
Michigan State
University

TEEPL E HARDWARE

BUILDER'S HARDWARE, PAINTS,
STOVES AND RANGES

PINCKNEY.

MICHIGAN

C. J. TEEPLE

M. L. TEEPLE

PROTECTION AT A MINIMUM COST

When in need of Fire Insurance you should consider:

- 1 *The Ownership of the Company*
- 2 *The Division of Profits*
- 3 *The Strength*
- 4 *The Reliability*
- 5 *The Financial Standing*

The Livingston County Mutual Fire Insurance Company is owned by its members as each policy holder is a member. These members share the profits of the company.

The Strength of the Company is vested in its 3027 members and the operation has always been toward the best interest of this membership. The reliability is above question, when we consider that this Company was established in 1863 and has been in operation ever since. The financial report for the year showed a balance of more than \$48,000.00 These are facts you should be interested in and when in need of Fire Insurance remember

The Livingston County Mutual Fire Insurance Co.

Phone 564

O. H. HOLMES; Sec.

Howell, Mich.

Brighton GREEN OAK

T. 1 N.

R. 6 E.

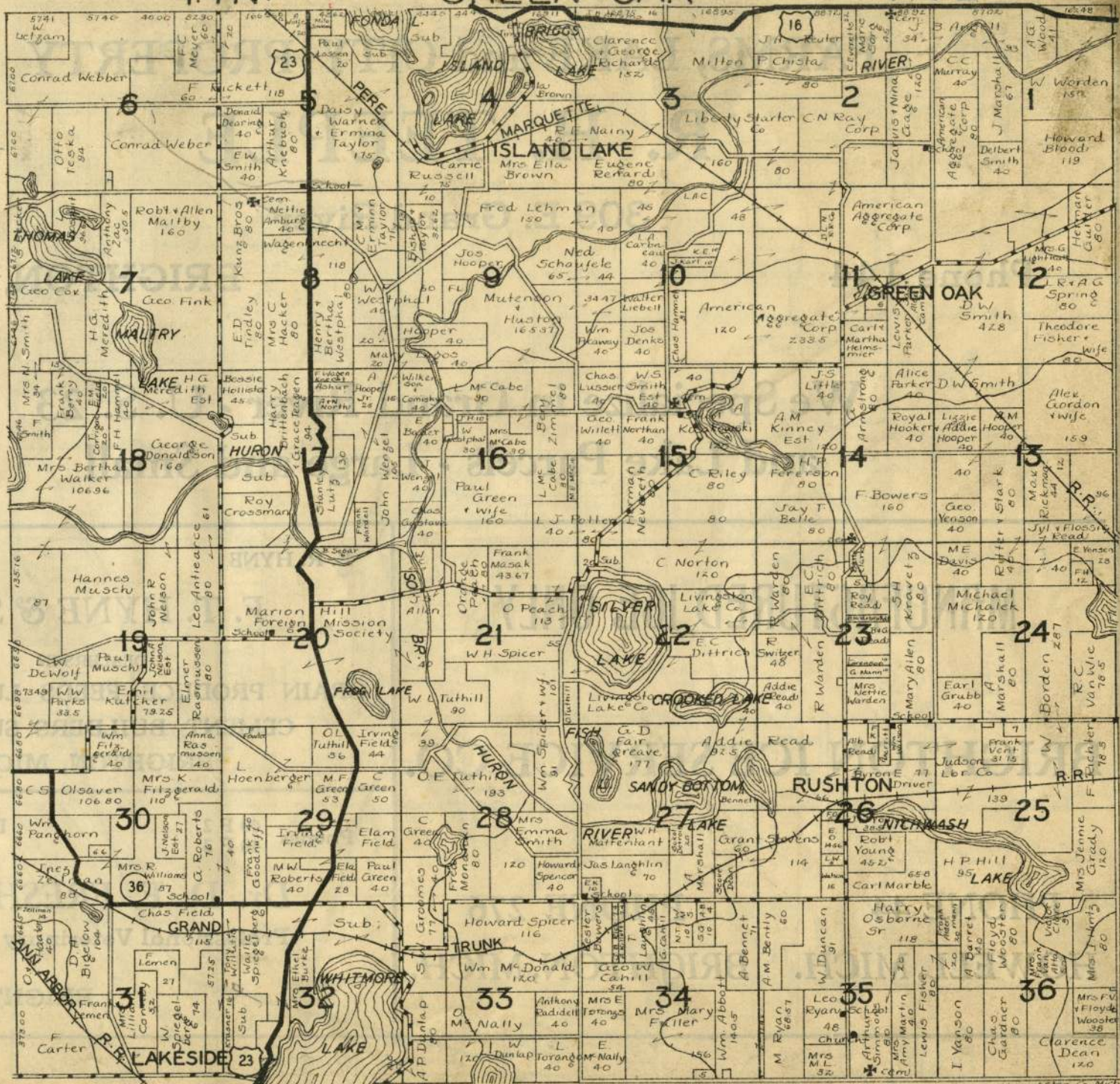

WELLE

HAMBURG

MAPS

G
1413
L6
R65
193-?

G
1413
.L6
H5
1930

FARMS, LAKE and CITY PROPERTY

R. H. TEEPLE

309 E. Grand River

Phone 144

BRIGHTON, MICH.

We Specialize in Grand River - U. S. 23
and Lake Parcels - Large and Small

MANUFACTURED ICE ONLY

BRIGHTON ICE SERVICE CO.

PHONE 44

HOWELL, MICH.

PHONE 276

BRIGHTON, MICH.

E. R. HYNE

PHONE 11 F-2

F. T. HYNE & SON

DEALERS IN

GRAIN PRODUCE FEEDS LUMBER COAL

CEMENT BUILDERS' SUPPLIES

BRIGHTON, MICH

Phones 40 F 2
40 F 3

DAY OR NIGHT

Dr. D. F. FRESHOUR

Professional Veterinary Services

BRIGHTON, MICH.

HARTLAND AREA MILLS
and **HARDWARE**
HARTLAND, MICH.

MILLER'S GAS STATION
Oils, Tractor Oils, Lubricating Greases,
Groceries

Phone 66 F 2

PINCKNEY, MICH.

SHIREY'S RADIO SERVICE

Phone 72

MAIN ST.

PINCKNEY, MICH.

C. N. HOLKINS

R. E. HOLKINS

C. N. HOLKINS & SON
LUMBER AND BUILDING SUPPLIES

Economy - Quality - Service

PHONE 264

HOWELL, MICHIGAN

Established 1865

Incorporated 1915

Mc Pherson State Bank
Howell, Michigan

YOUR BUSINESS ALWAYS APPRECIATED

SPEARS SERVICE STATION

GULF GAS

GOODYEAR TIRES

Phone 55

Pinckney, Michigan

HOWELL'S
"BETTER REAL ESTATE SERVICE"

EARL A. SHARPE

Real Estate Business Chances and Broker

HOUSES
FARMS
CITY
LAKE PROPERTY
RENTALS

Howell, Mich.

Phone 164 or 244

TYRONE
T.3N.

HARTLAND

R.6E.

CEOLA

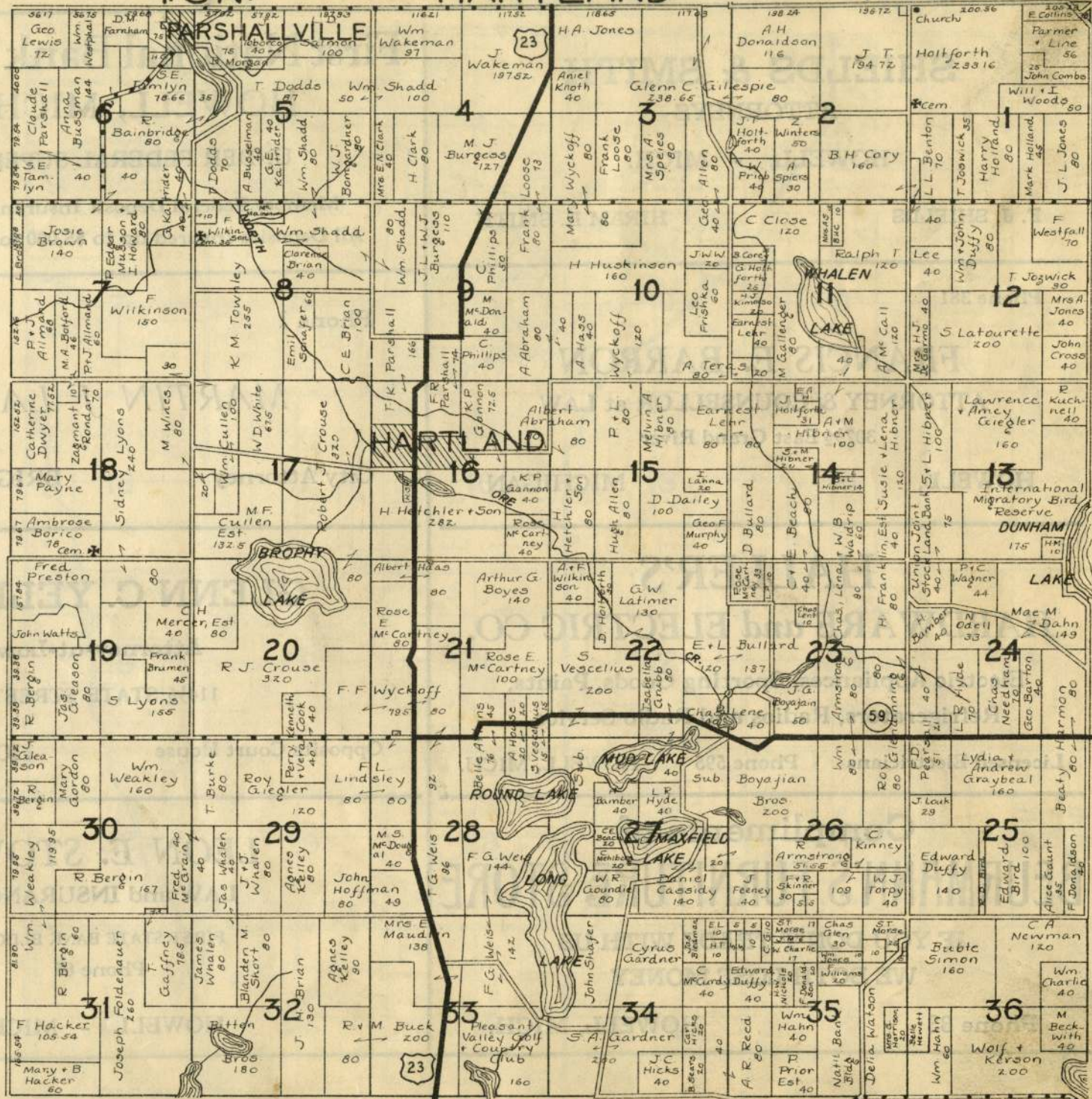

BRIGHTON

Livingston G. Nick

SHIELDS & SMITH

ATTORNEYS

HOWELL, - MICH.

F. J. SHIELDS

HIRAM R. SMITH

Phone 381

FRANCIS E. BARRON

ATTORNEY & COUNSELLOR at LAW

307½ East Grand River

HOWELL,

MICHIGAN

HALLER'S

HARDWARE and ELECTRIC CO.

Electric Appliances, Sporting Goods, Paints,
Refrigerators, Radios and Radio Service

Licensed Electricians

Phone 595

HOWELL, MICH.

Compliments of
BEURMANN'S FURNITURE STORE

IF YOU DON'T TRADE WITH US
WE BOTH LOSE MONEY

Phone 83

HOWELL, MICH.

First National Bank in Howell

HOWELL, MICHIGAN

UNDER FEDERAL SUPERVISION

Member Federal Deposit Insurance Corporation
All Deposits Insured up to \$5,000 for each Depositor

Phone 1

MARTIN J. LAVAN

City Attorney

BRIGHTON, MICH.

GLENN C. YELLAND

Attorney-at-Law

114½ STATE STREET

Opposite Court House

HOWELL, MICH.

LEON E. STOWE

LAW and INSURANCE

FIRST STATE BANK BLDG.

Phone 65

HOWELL - MICH.

T.4N.

TYRONE

R.6E.

PEERFIELD

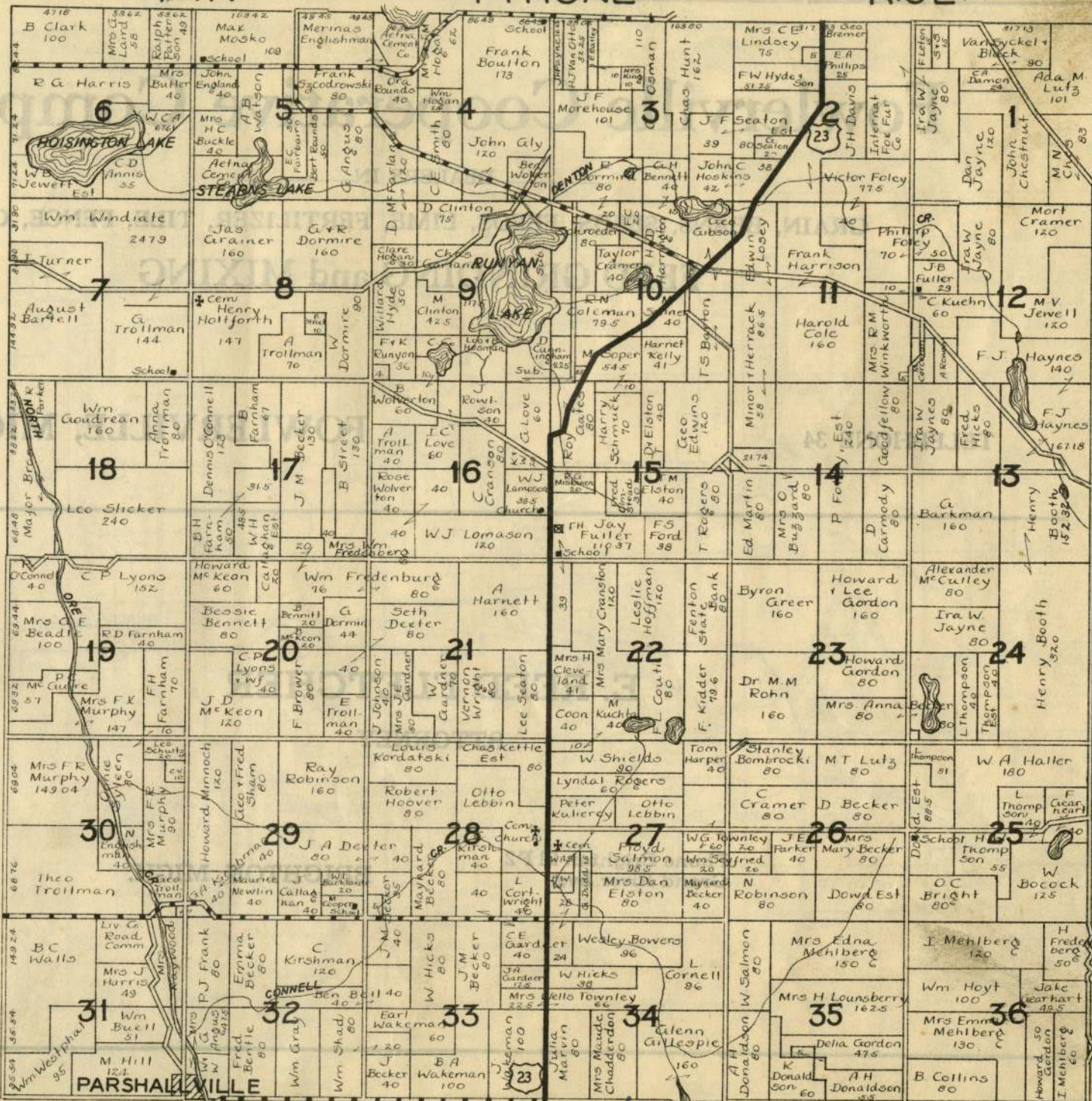

PARSHALLVILLE

Fowlerville Cooperative Company

DEALERS IN

GRAIN, BEANS, SEEDS, FEEDS, LIME, FERTILIZER, TILE, FENCE, COAL
FEED GRINDING and MIXING

TELEPHONE 34

FOWLERVILLE, MICHIGAN

E. REED FLETCHER

ATTORNEY

Phone Brighton 21 F 2
Grand River Ave.

BRIGHTON, MICH.

GENOA

TIN.

HAMBURG

R5E.

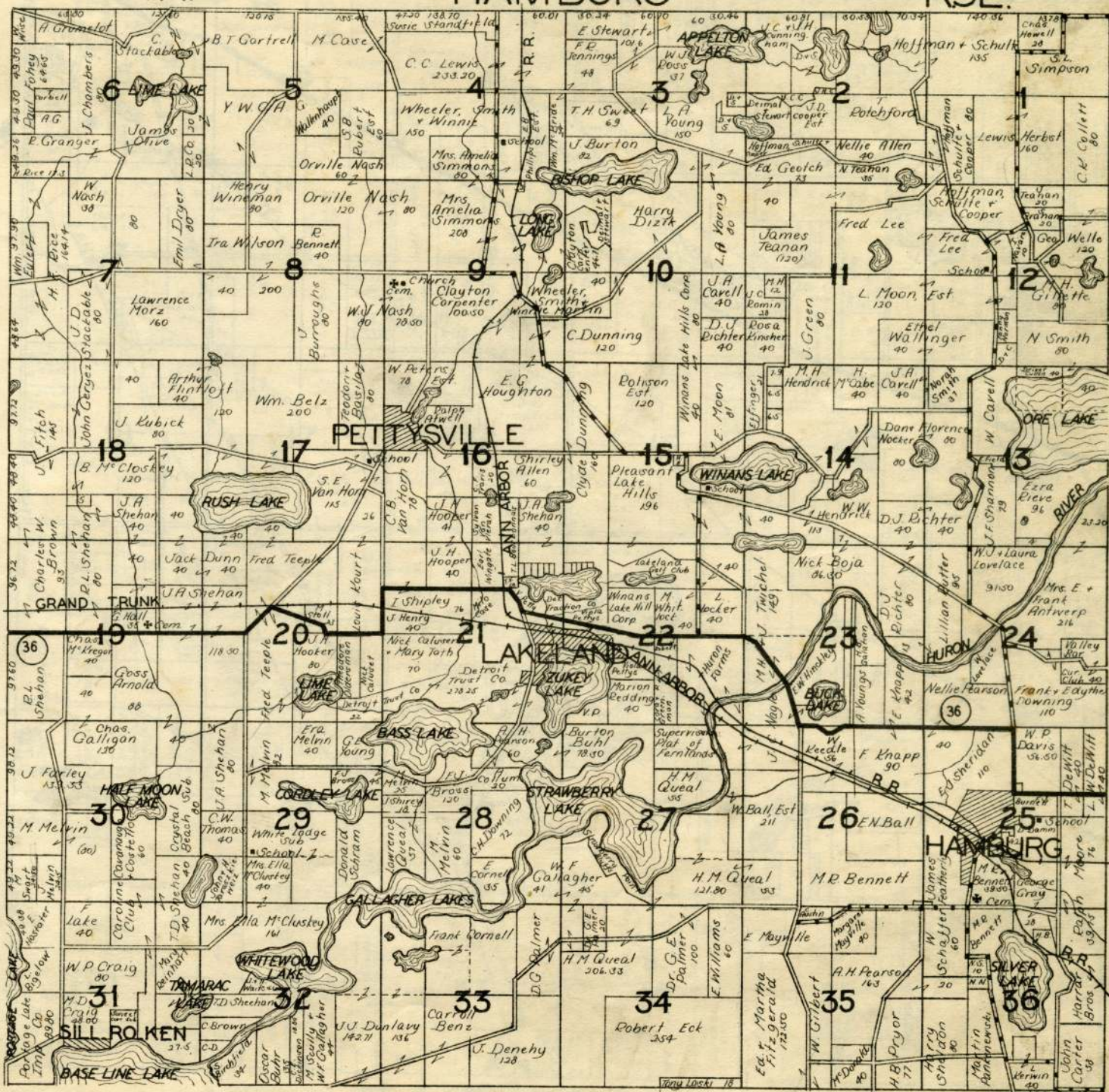

P. 2 T N A M

WELUE

Green oak

GENOA

T.2N.

GENOA

R.5E.

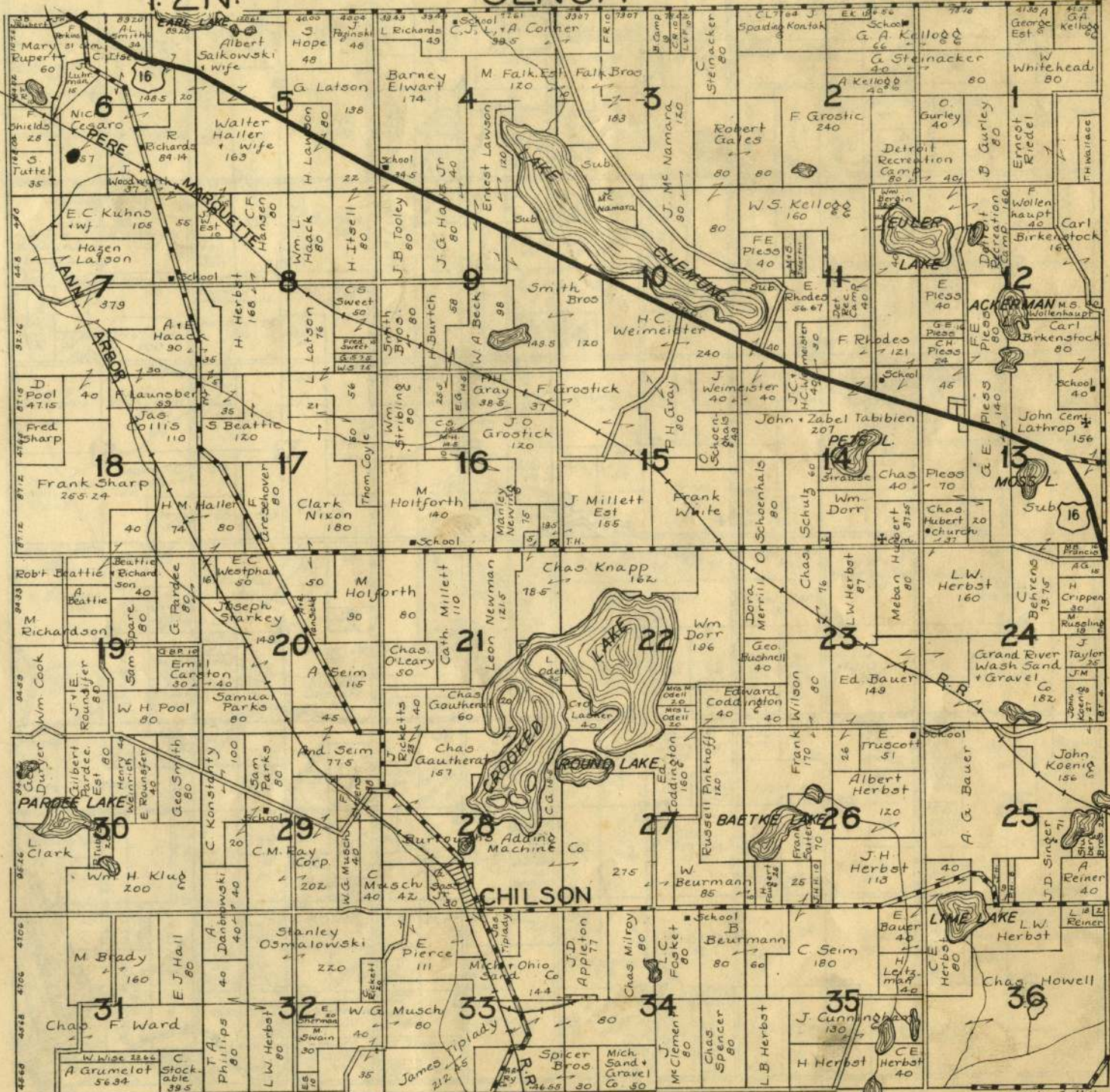

not will
 T →

M A R I O N

B r i g h t o n

H a m b u r g

Livingston Co. Mich

T.3N.

DEERFIELD

OCEOLA

R5E.



Howell
Coburn

HIRTLAND

GENOA

Livingston Co. Mich.

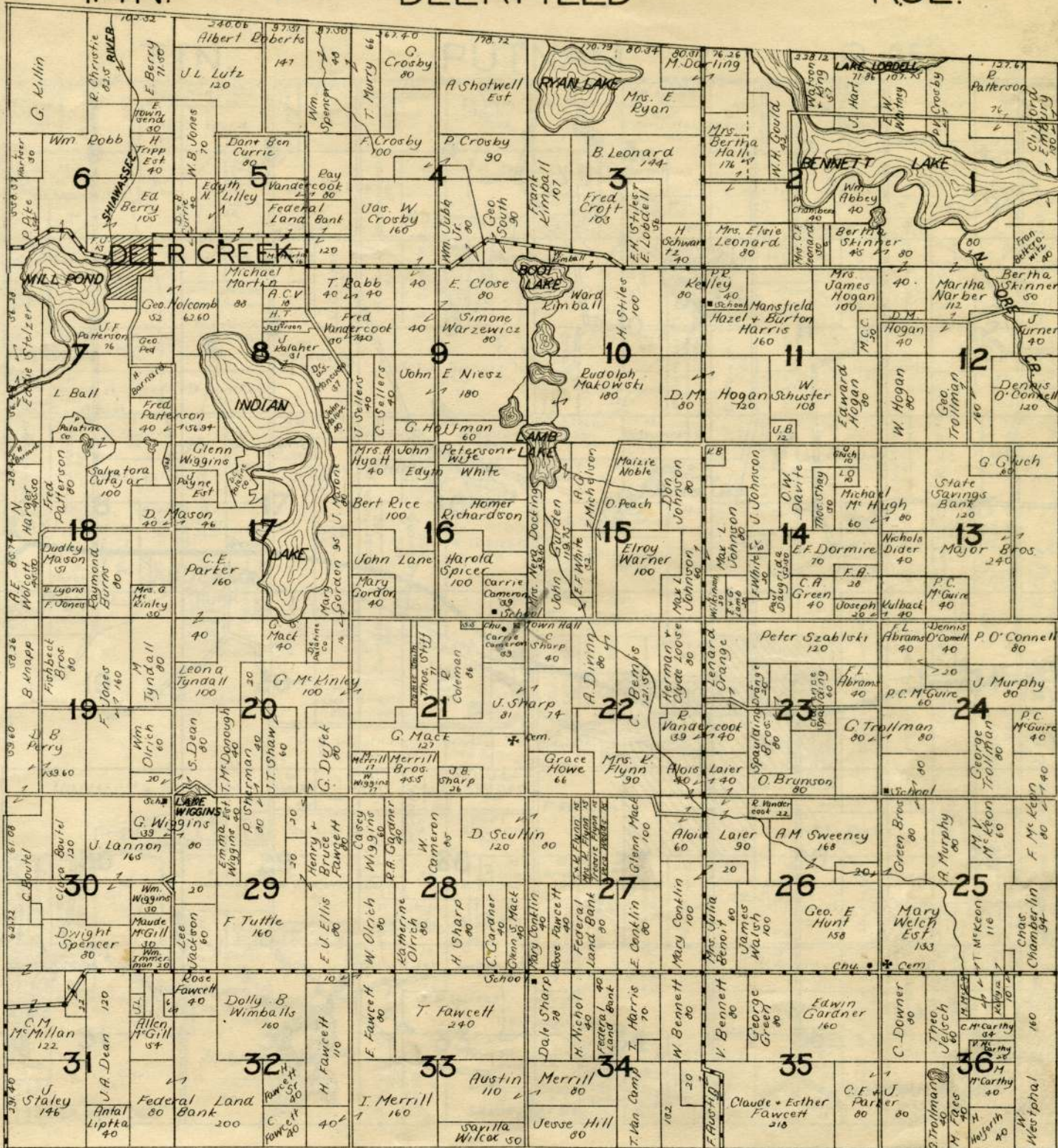

H. G. W. E. P. F. T. A. H.

TYRONE

C. H. O. E. T. A. H.

OCEOLA

MARTON

T.1N.

PUTNAM

R.4E.

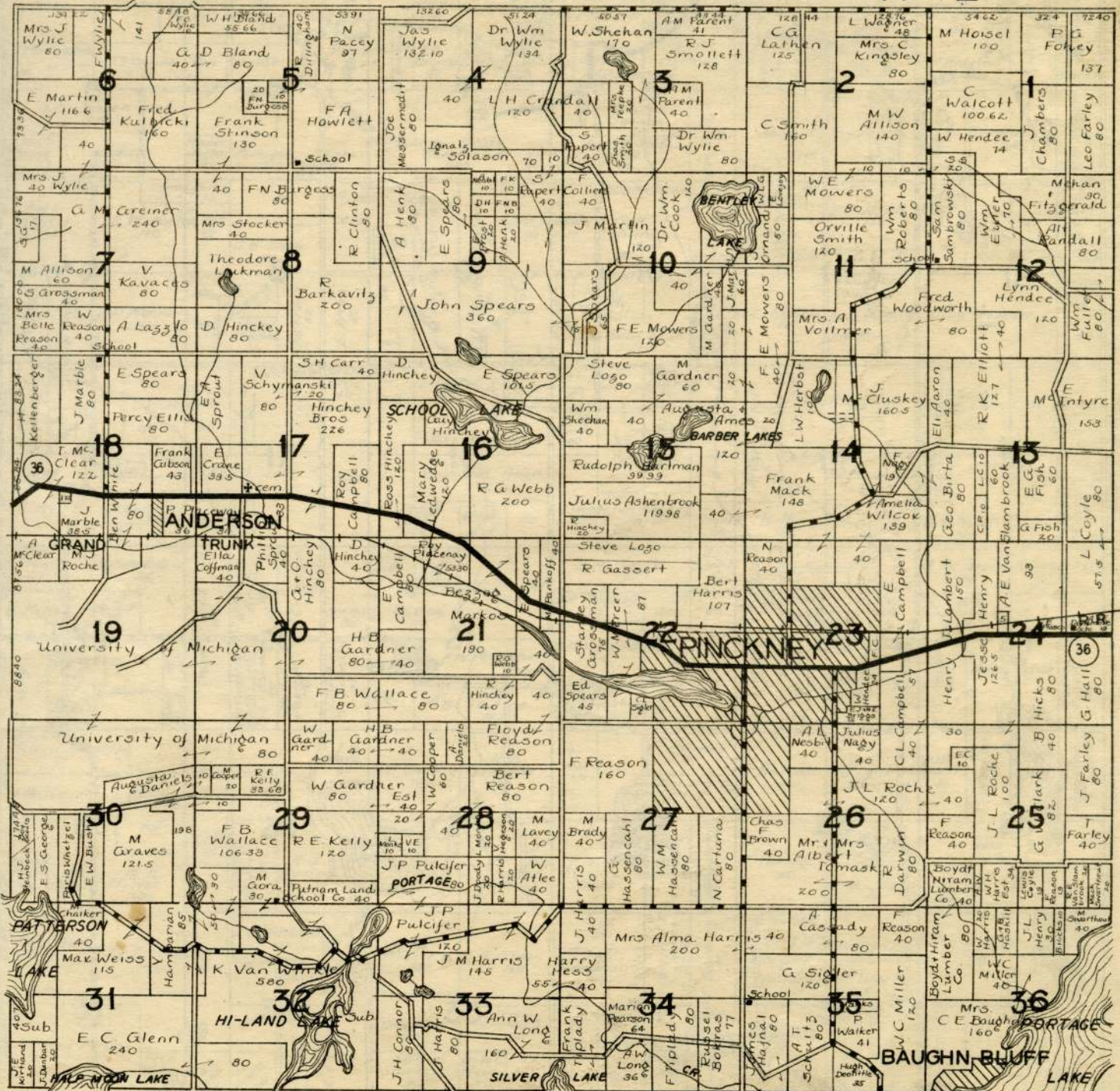

6096 NAT 5050
V.N.A d i L L A

Harmburg

Livingston, CalMech

T2N. HOWELL MARION R4E.

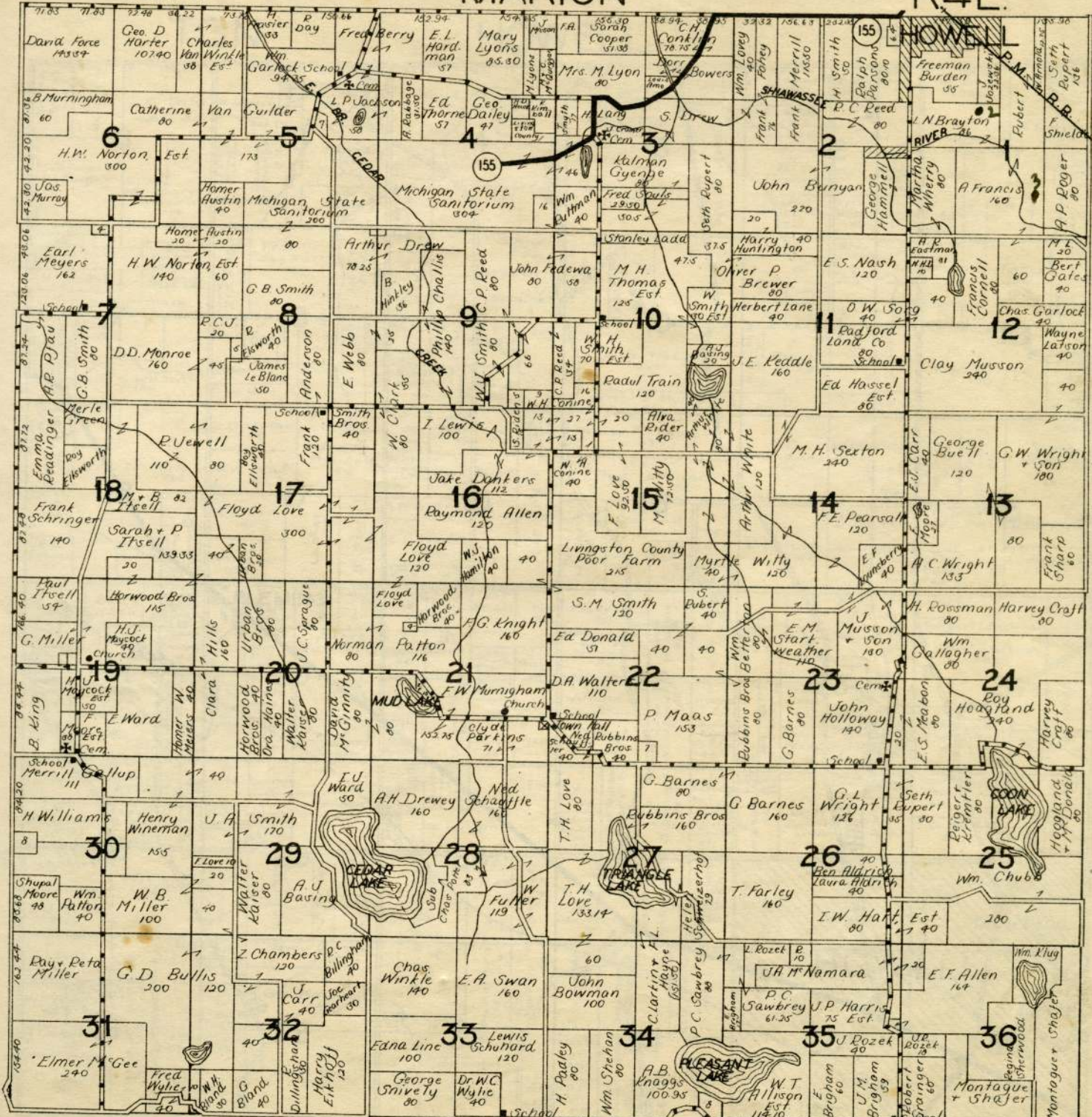

old well

D E N O A

10501

PvTMAm

ECHOETAK

T.3N.

HOWELL

R.4E.

Handy

MARION

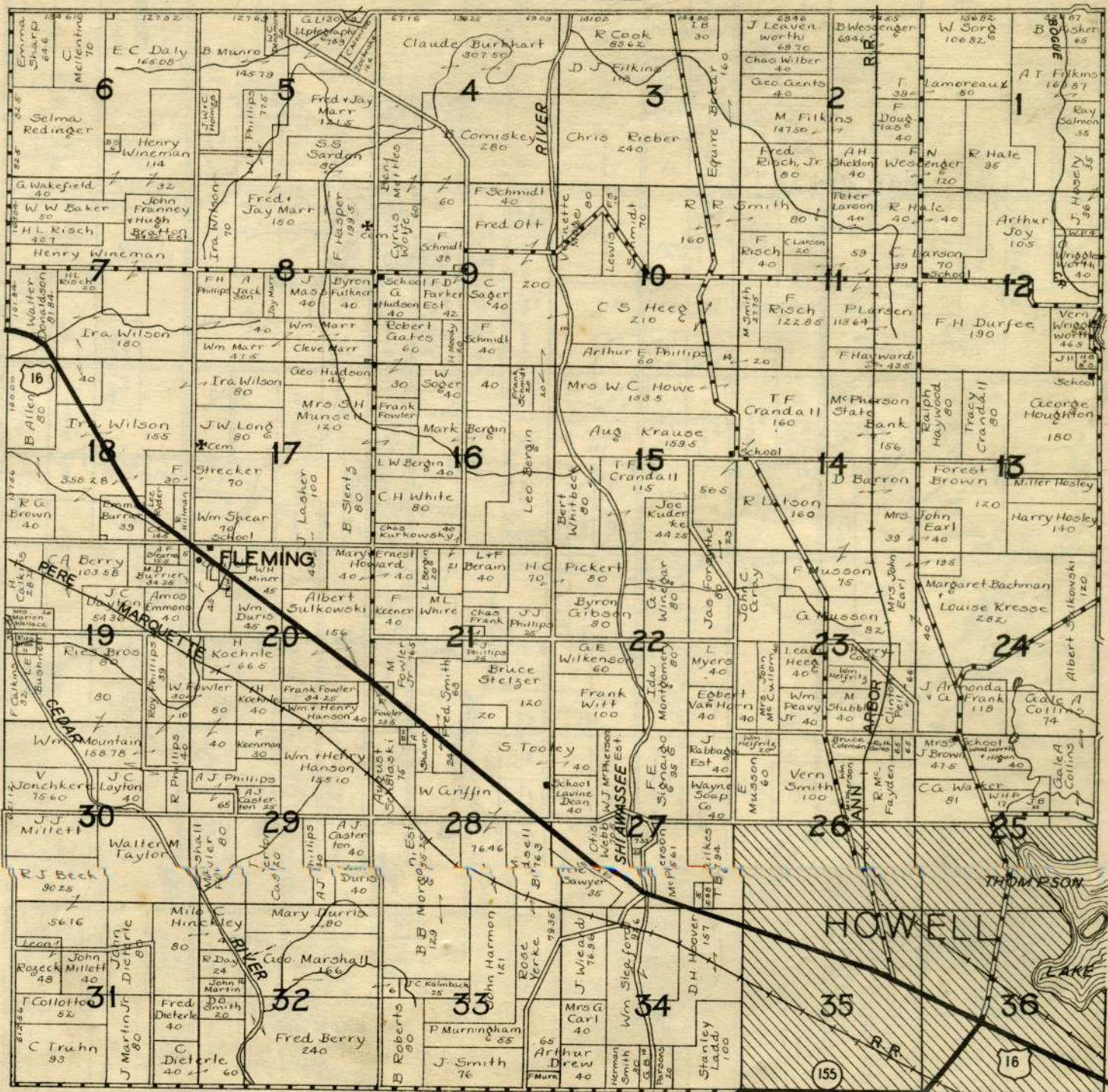

OCEOLA

T.4N.

COHOCTAH

R.4E.

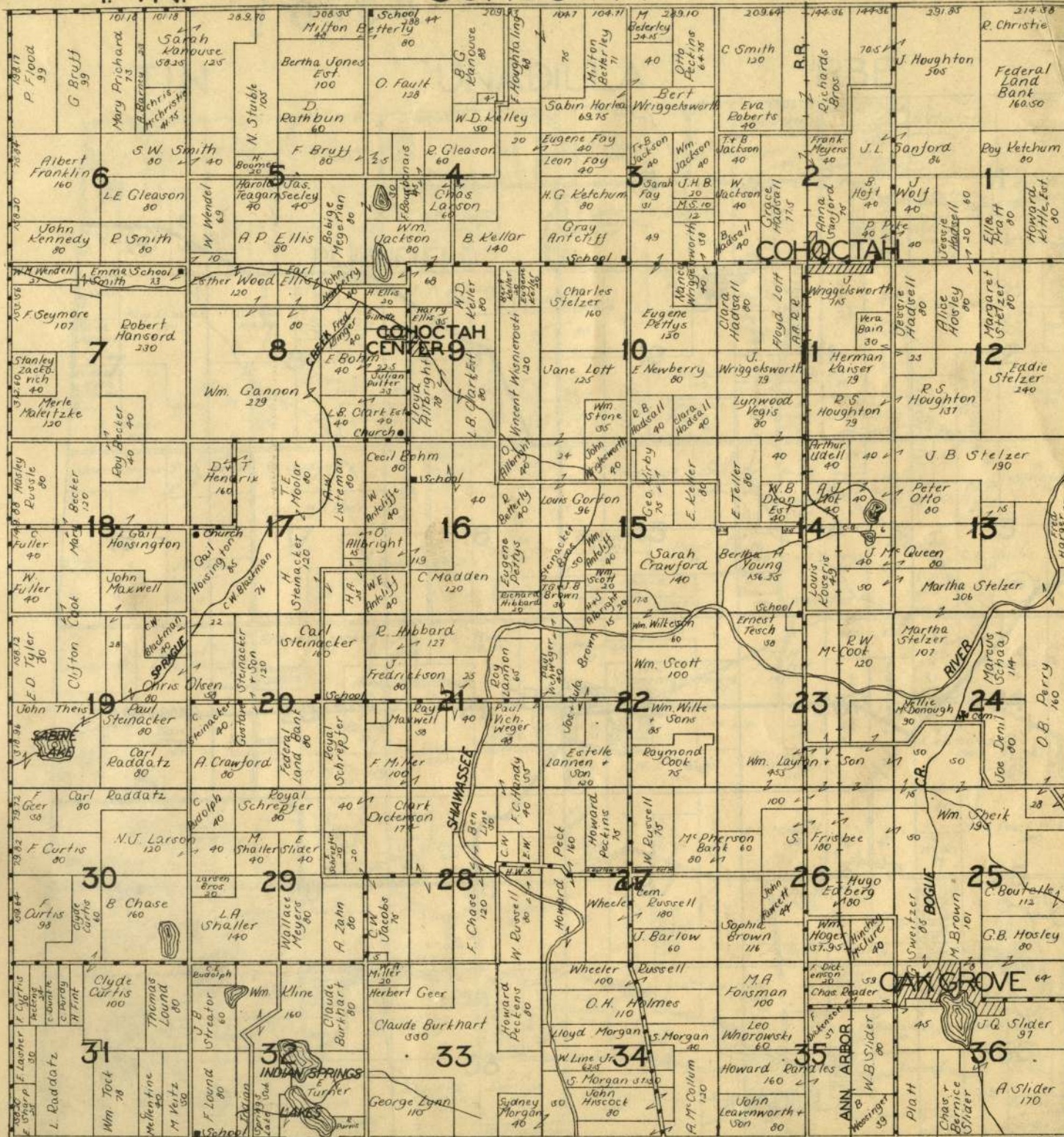

CONWAY

VEERFIELD

HOWELL

10500

T.1N.

UNADILLA

R3E.

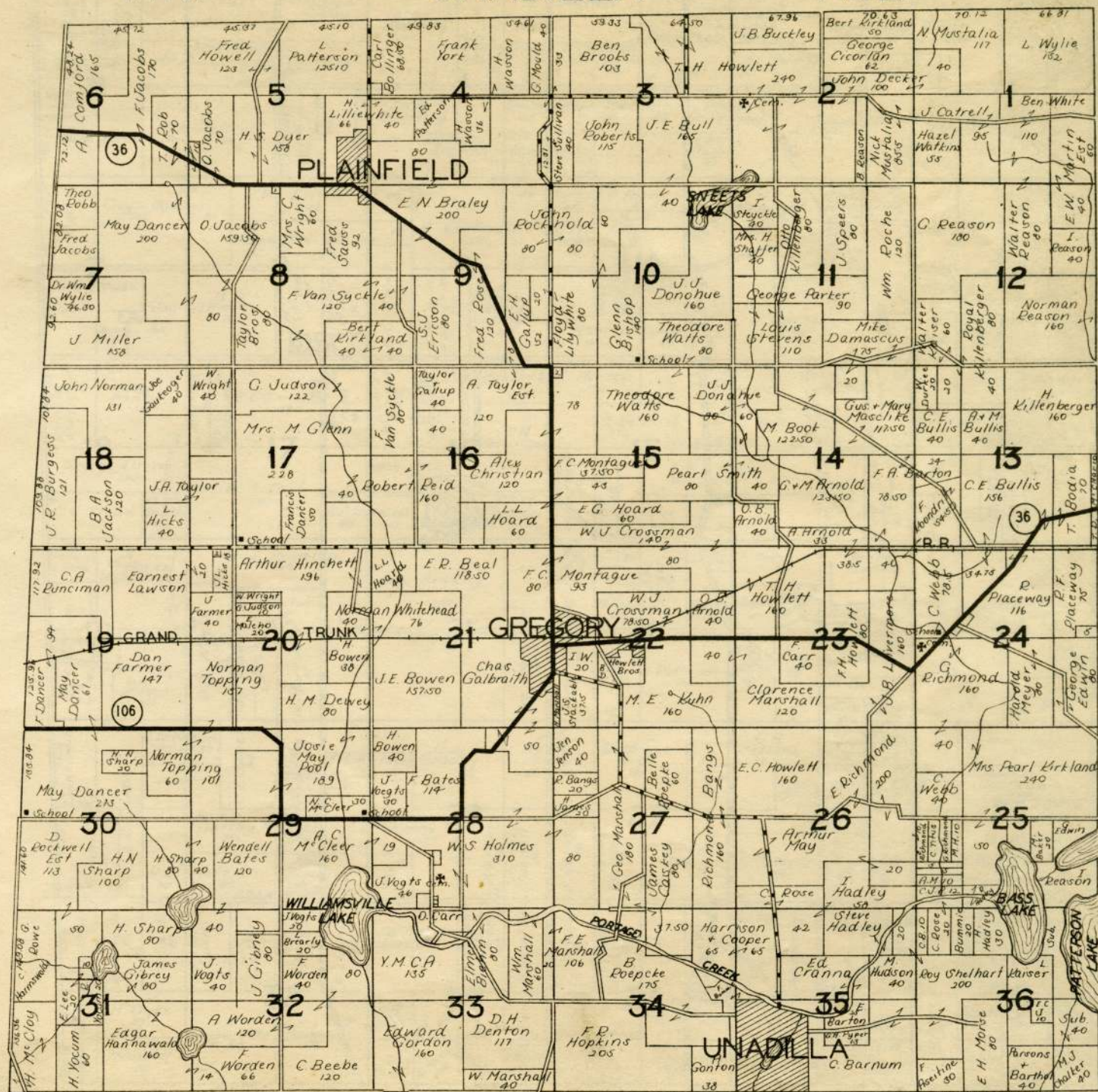

PUTNAM

HANDY

T.2N.

IOSCO

R.3E.

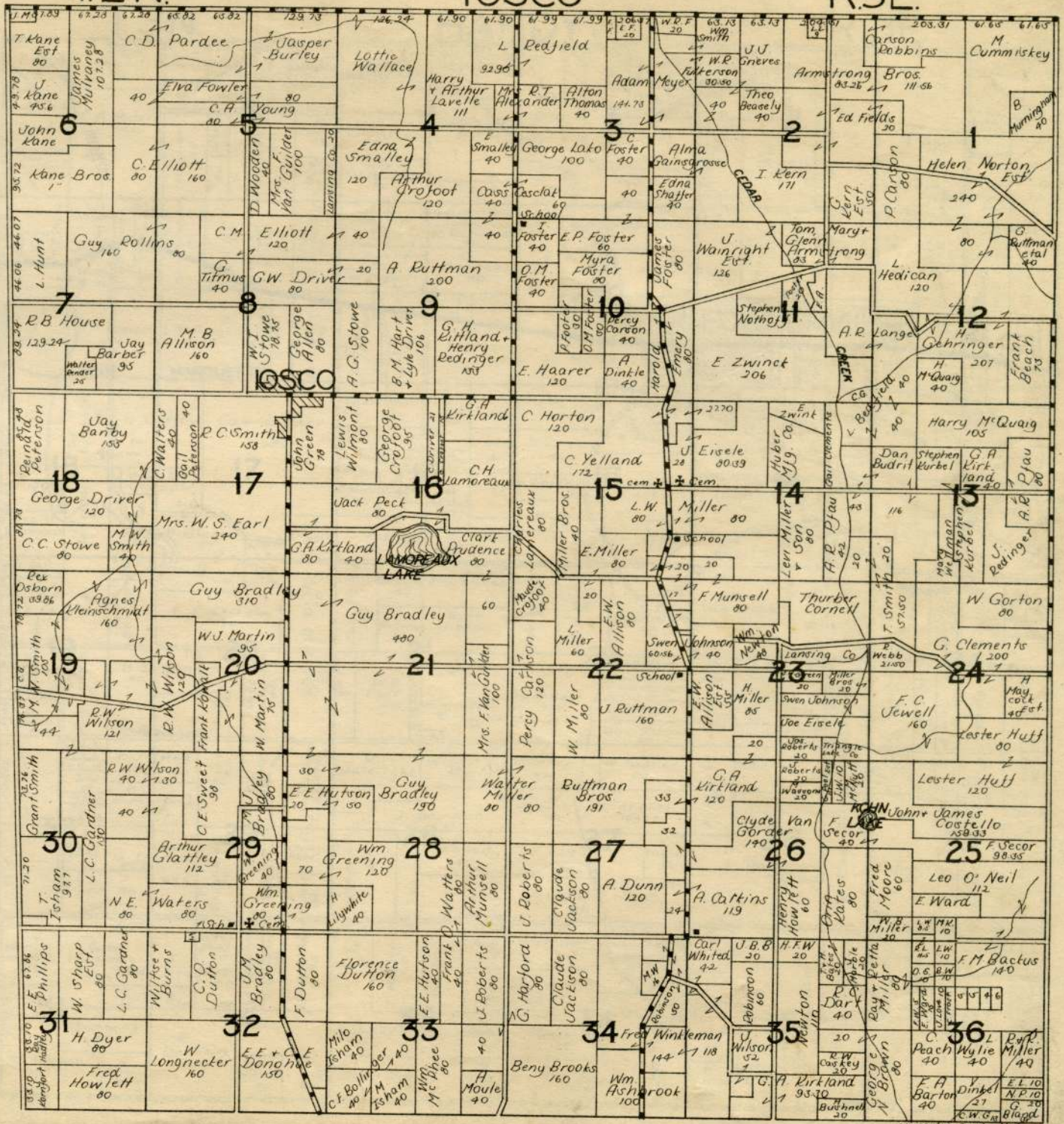

MARION

UNADILLA

CONWAY

T.3N.

HANDY

R.3E.

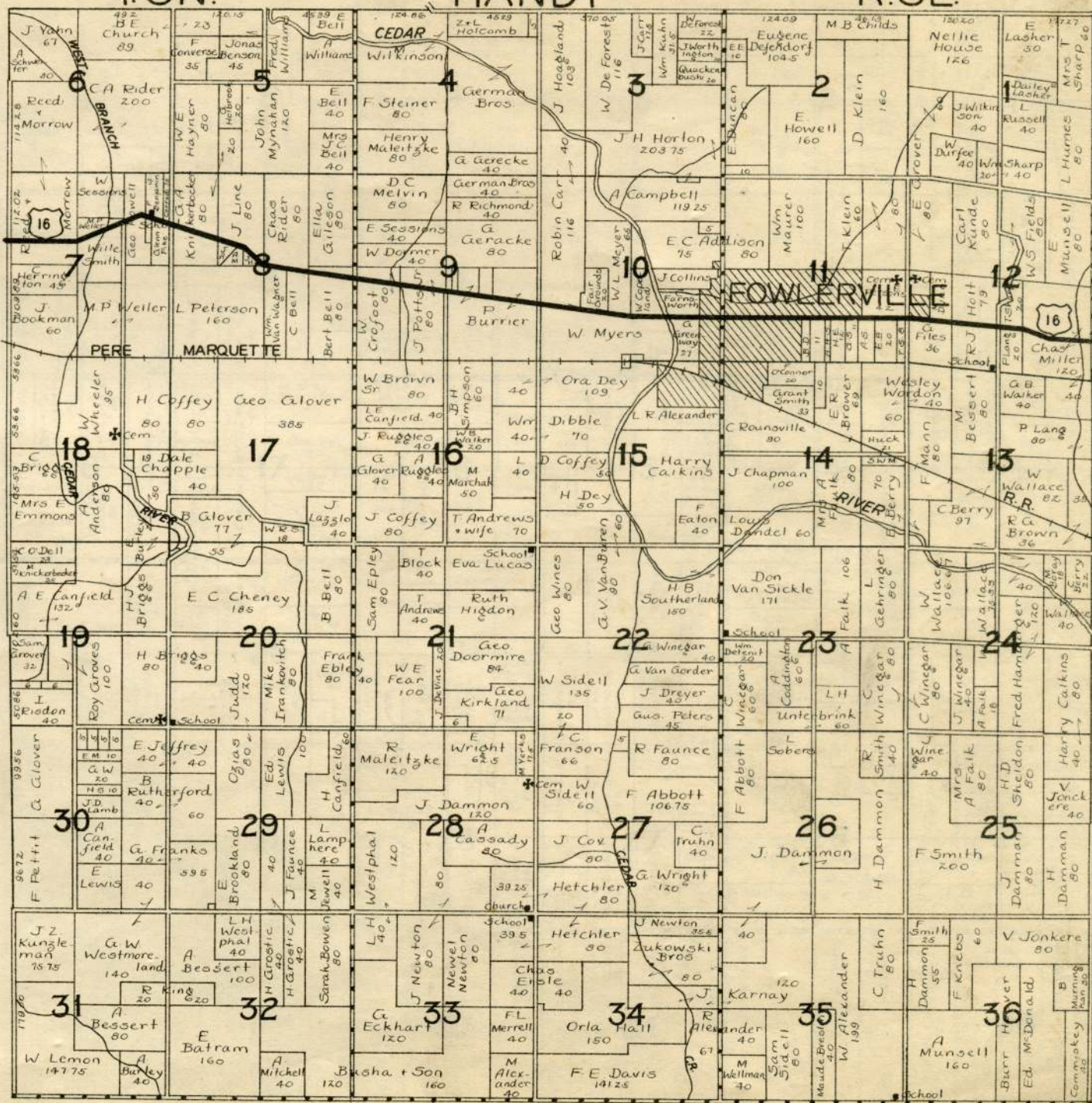

HOWELL

10500

T.4N.

CONWAY

R.3 E.

172.79 N M Wilson 246.56	256.56 V Haas	880.6 Wallace Short 79.04	880.6 Frank Witter 94.84	129.0 B Tobias 30	180.91 Cassady 30.34	184.31 E Colborn 90	184.31 M Colborn 42	188.86 Kate Flynn 45	271.34 Roy T Sprague 181.54	31.25 C Fye	31.25 John Harris 86	193.44 L Sober 149.19	193.44 J Hall 51	201.77 Geo Sweben 105	201.77 McParson 103.83	211.03 C Stuble
7376 Ed Fisher 62.04	6 A Sedon 65	7376 N Simpson 35	7376 W Harris 60	7376 H Cole 40	7376 A Darling 40	7376 Fred Cradall 80	7376 H Johnson 120	7376 Thomas Dailey	7376 Geo Horn 40	7376 R+L Wall 71.22	7376 Leon Minor 160	7376 P Flood 60	7376 A Suikco 80	7376 E Young 150	7376 John Oliver 40	7376 Roy + Mary 80
12745 G Ryce	12745 N Case 42	12745 F+L Dillingham 165	12745 W Kelley 80	12745 Fred Wilkinson 80	12745 J A Duncan 80	12745 H Dietrich 120	12745 A Dietrich 80	12745 Mrs L S Voot 220	12745 LB Haag 80	12745 W Copeland 50	12745 E A Cole 160	12745 W F Roby 320	12745 W Hendryk 80	12745 J Holmes 80	12745 F Wilkinson + C Copeland 80	12745 Michael Gentile 90
12745 L Liverance + Cassady	12745 Eoy + Fay Dillingham 80	12745 L Dillingham 80	12745 Geo Dryer 80	12745 L Hillman 40	12745 C W Benjamin 80	12745 J B Rambo 80	12745 P D + M Parker 80	12745 A Tomlin 40	12745 B Mohrle 80	12745 H V Sobel 80	12745 C Dorman 80	12745 Rathburn 80	12745 R Chambers 80	12745 W Holcomb 80	12745 J Oliver 120	12745 J Holmes 80
12745 L Liverance	12745 A Chase 52	12745 L M Pearson 70	12745 J Glenn 80	12745 Daisy Pulling 40	12745 C W Benjamin 120	12745 A Boardway 80	12745 L Grover 40	12745 Gus Thomas 195	12745 Lester Raymer 80	12745 H Chang 40	12745 G Klein 110	12745 LF + C Layton 80	12745 Mrs C Bigelow 80	12745 Nettie Bigelow 80	12745 Ar M Mackenzie 40	12745 Roy Secord 80
4433 J B Allen 300	4433 A C Woolley 80	4433 Archie King 80	4433 Fred Antcliff 80	4433 Wm Shirey 80	4433 F Antcliff 40	4433 A King 80	4433 John Sariscany 80	4433 L H West 80	4433 Roy Secord 80	4433 F M Killinger 80	4433 M Snyder 80	4433 Mrs C Bigelow 80	4433 Nettie Bigelow 80	4433 Ar M Mackenzie 40	4433 Roy Secord 80	4433 C I E Ladaur 40
4003 H M Hines 60	4003 Herbert Aivator 80	4003 Hugh Loughtin 160	4003 Wm Ash 80	4003 Wm Kuehn 50	4003 Tans Sherwood 80	4003 C F Ward 80	4003 John Becker 80	4003 A M Morlock 40	4003 EH Morlock 80	4003 A H Morlock 80	4003 Frank Salforsky 80	4003 H Kline 50	4003 J M Snyder 50	4003 Karl Schmidt 60	4003 P Doherr 80	4003 C Doherr 200
3816 E + M Heinrich	3816 R Allen 78	3816 C D Rose 160	3816 N Stage 80	3816 L Miller 115	3816 F Hoyt 80	3816 John Carusi 80	3816 A H Morlock 80	3816 Bert Kirkland 80	3816 V J Sherwood 98	3816 H V Day 40	3816 Minnie Purdy 160	3816 C L Gordon 120	3816 P Doherr 40	3816 L Radday 80	3816 J Duncan 40	3816 J Duncan 40
3426 Otto Pearson 114.38	3426 W E Stowe Est 160	3426 S Allen 79.25	3426 Lottie Duncan 60	3426 M Barnhouse 40	3426 E Miller 100	3426 N Holmes 60	3426 Leticia Parsons 80	3426 N Holmes 80	3426 AV Jones 86	3426 Guy Blair 40	3426 Simon Vogt 80	3426 R J Robb 160	3426 Fritz Kunde 80	3426 G D Converse Est 80	3426 G A Adams 59	3426 H R Wilkinson 100
3426 E H Lewis 110	3426 Fred Stowe 70	3426 E Hatt 80	3426 C T Allen 80	3426 Claude Hickey 80	3426 David DeWatters 80	3426 A R Grant 40	3426 G Grant 40	3426 M Gould 80	3426 W Barnard 80	3426 W Bernard 80	3426 Rollin Horton 120	3426 L G Eaton 40	3426 J Sharp 85	3426 John Ellsworth 60	3426 H G Wilkinson 160	3426 Maurer 30
3426 J Yahng	3426 F Anderson 150	3426 N Nier 43	3426 G Grant 40	3426 G Grant 40	3426 G Grant 40	3426 G Grant 40	3426 G Grant 40	3426 G Grant 40	3426 G Grant 40	3426 G Grant 40	3426 G Grant 40	3426 G Grant 40	3426 G Grant 40	3426 G Grant 40	3426 G Grant 40	3426 G Grant 40
3426 CEDAR RIVER	3426 CEDAR RIVER	3426 CEDAR RIVER	3426 CEDAR RIVER	3426 CEDAR RIVER	3426 CEDAR RIVER	3426 CEDAR RIVER	3426 CEDAR RIVER	3426 CEDAR RIVER	3426 CEDAR RIVER	3426 CEDAR RIVER	3426 CEDAR RIVER	3426 CEDAR RIVER	3426 CEDAR RIVER	3426 CEDAR RIVER	3426 CEDAR RIVER	3426 CEDAR RIVER

HANDY

COHOETAN

Member of International B. C. Association
Michigan Poultry Improvement Association

White Leghorns - Barred Rocks
Gies - Woodworth White Rocks

OUR FARM OFFICIALLY U. S. APPROVED

GIES POULTRY FARM

1301 Byron Road Telephone 159
HOWELL, MICH.

More profits assured with our special features in breeding livability in our heavy production large-type birds. High White Rock Hen at official 1937 Mich. Egg Laying Contest at East Lansing; 592 Eggs, 297 Points. High Hen at 1938 Florida Egg Laying Contest. 262 Eggs, 279 Points

Winners at Michigan State Production Shows For Over 10 Years

Funeral Directors

F. G. SCHNACKENBERG & SON

"Over $\frac{1}{3}$ of a Century in Howell"

Ambulance Service

Funeral Home

Telephone 48

312 So. Michigan Ave.

Livingston County Farm Bureau

ONE MAN Alone WILL NOT

- 1 Be able to increase tariffs against foreign vegetable and other cheap substitutes that now compete with American farm products.
- 2 Be able to secure a more just portion for farmers of the Nation's annual income and correct situation wherein farmers making up 25 per cent of the people of the United States and owning 21 per cent of the wealth receive less than 10 per cent of the Nation's annual income.
- 3 Be able to increase farmers patronage and co-operative business so as to continue to make quality merchandise available at economical prices.
- 4 Be able to work effectively for a happier and more prosperous farm life.

THIS IS BUT PART OF YOUR FARM BUREAU'S PROGRAM

-- IF WE WANT TO GET THESE JOBS DONE --

LET'S GO IT TOGETHER

JOIN THE LIVINGSTON COUNTY FARM BUREAU TODAY!



A Ford Dealer Since 1915

RUSSELL D. SMITH

Phone 40

Howell, Mich.

FORD - MERCURY - LINCOLN ZEPHYR

SALES



SERVICE

AUTOMOBILES

FORD TRUCKS and COMMERCIAL UNITS

FORD TRACTOR & FORD FERGUSON IMPLEMENTS

HI-SPEED GAS & OILS R & G USED CARS

Buy Dependable Products From a Reliable Dealer

Mc Pherson & Uber

INSURANCE

Fire - Tornado - Casualty - Bonds

124 W. GRAND RIVER

HOWELL, MICH.

PHONE 52

PHONE 617

The Mc Donald Funeral Home

*Quality Day and Night
Ambulance Service*

315 North Michigan Avenue

PHONE 506

HOWELL MICH.

L. H. CRANDALL

REAL ESTATE

FARMS A SPECIALTY

321 E. GRAND RIVER

HOWELL, MICH.