

M

P

G
1413
.C3
R6
193-?

PLAT BOOK

OF

CASS COUNTY
MICHIGAN

Published by

W.W.HIXSON & CO.

Rockford, Illinois

**MICHIGAN STATE UNIVERSITY
MAP LIBRARY
ROOM USE ONLY**

**LIBRARY
Michigan State
University**

20832

T.8S.

SOUTH PORTER

R.13W.

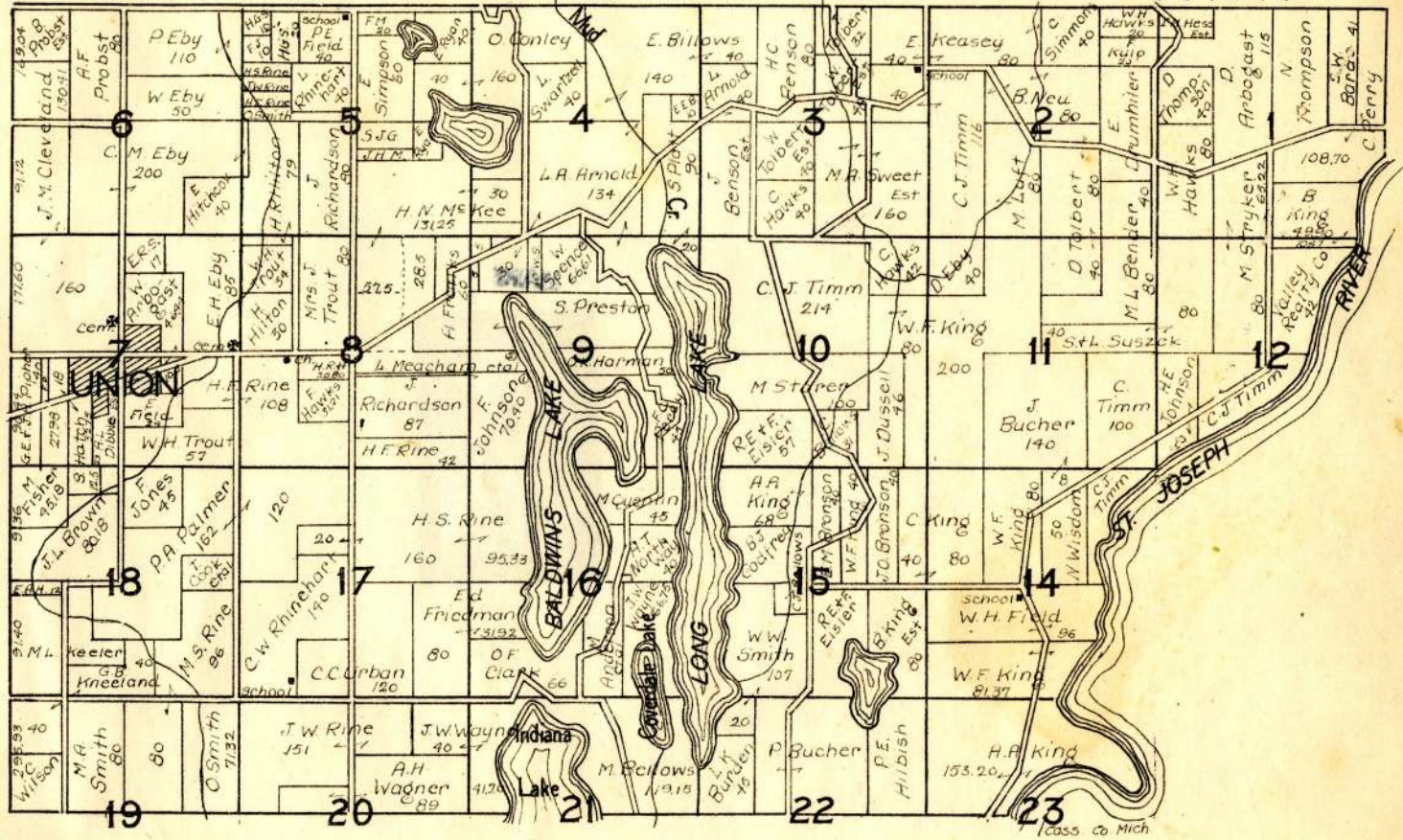

PLACE IN RETURN BOX to remove this checkout from your record.
TO AVOID FINES return on or before date due.
MAY BE RECALLED with earlier due date if requested.

DATE DUE	DATE DUE	DATE DUE

MAPS

G

1413

.C3

R6

1930?

T. 6S.

NEWBERG

R. 13W.

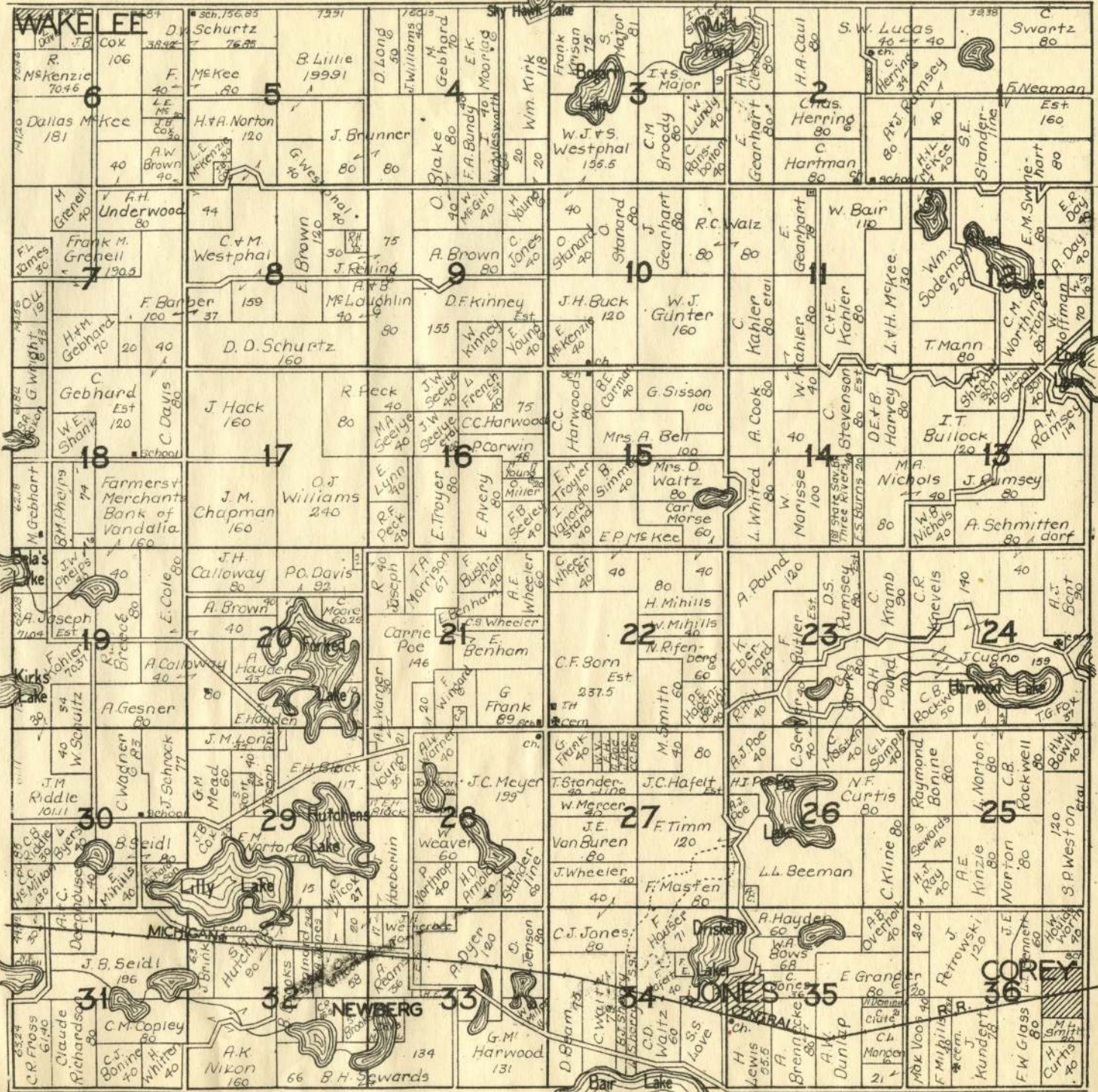

T.5S.

MARCELLUS

R.13W.

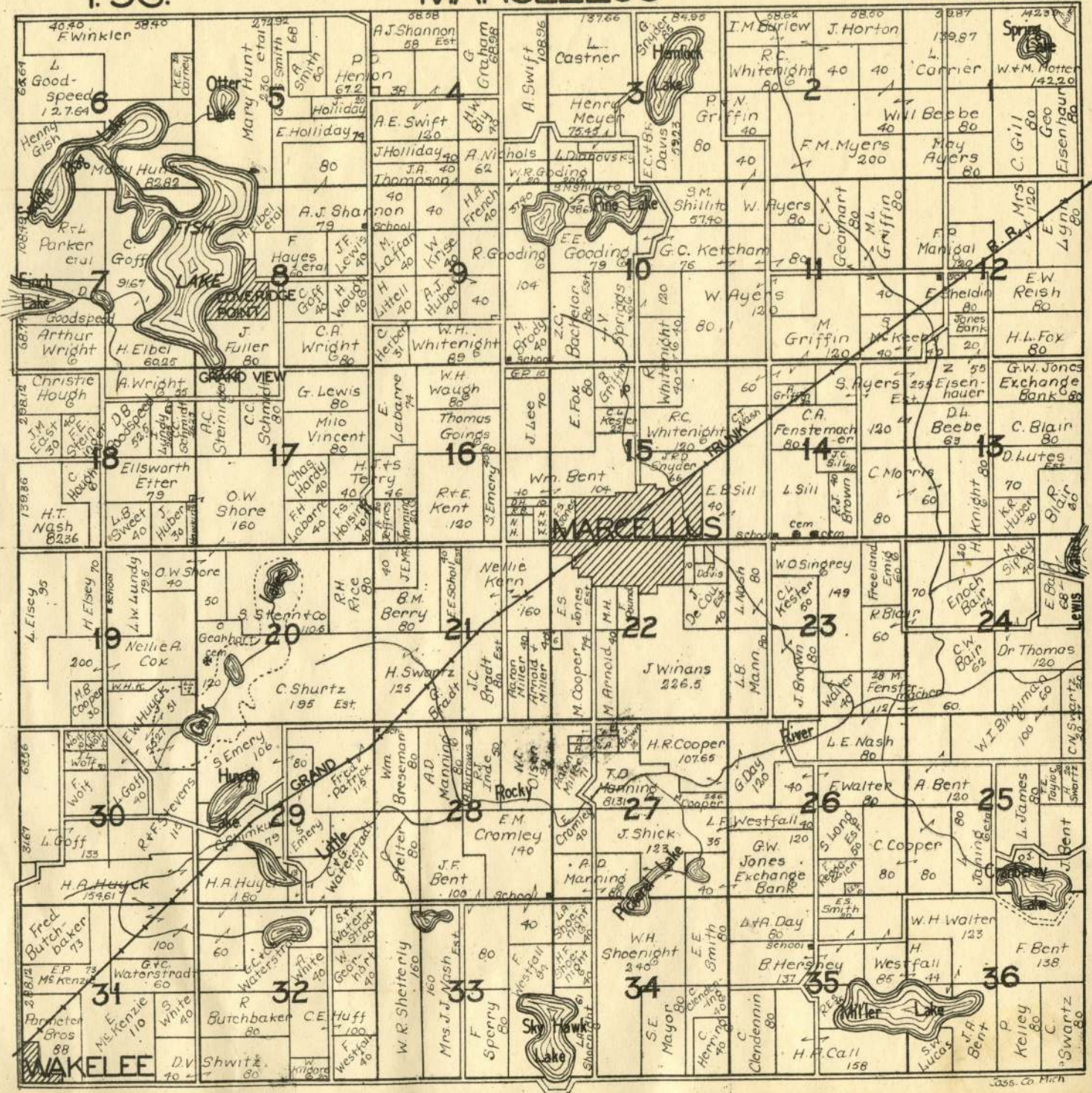

T.8S.

MASON

R.14W.

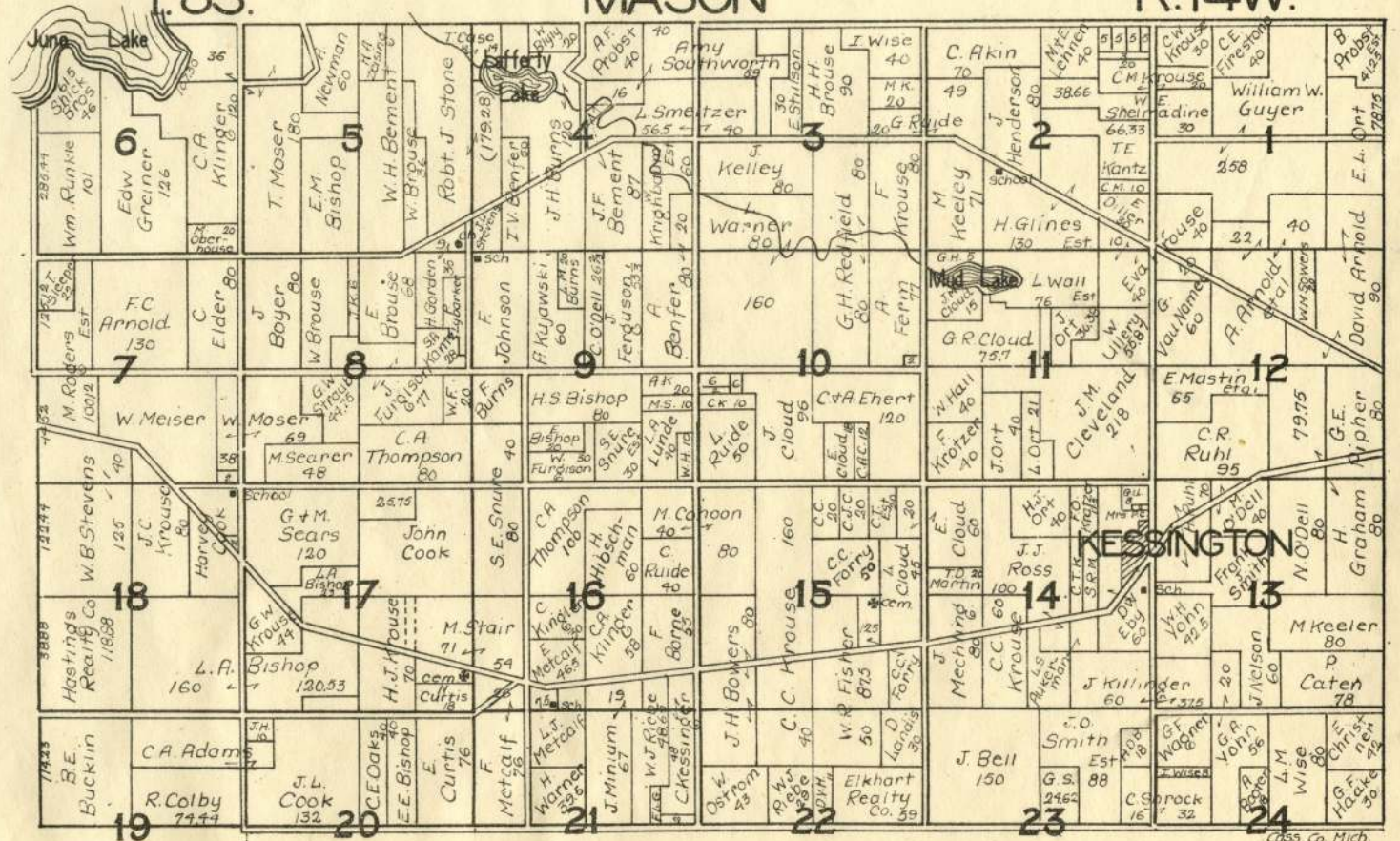

Cass Co Mich

T.7S.

CALVIN

R.14W.

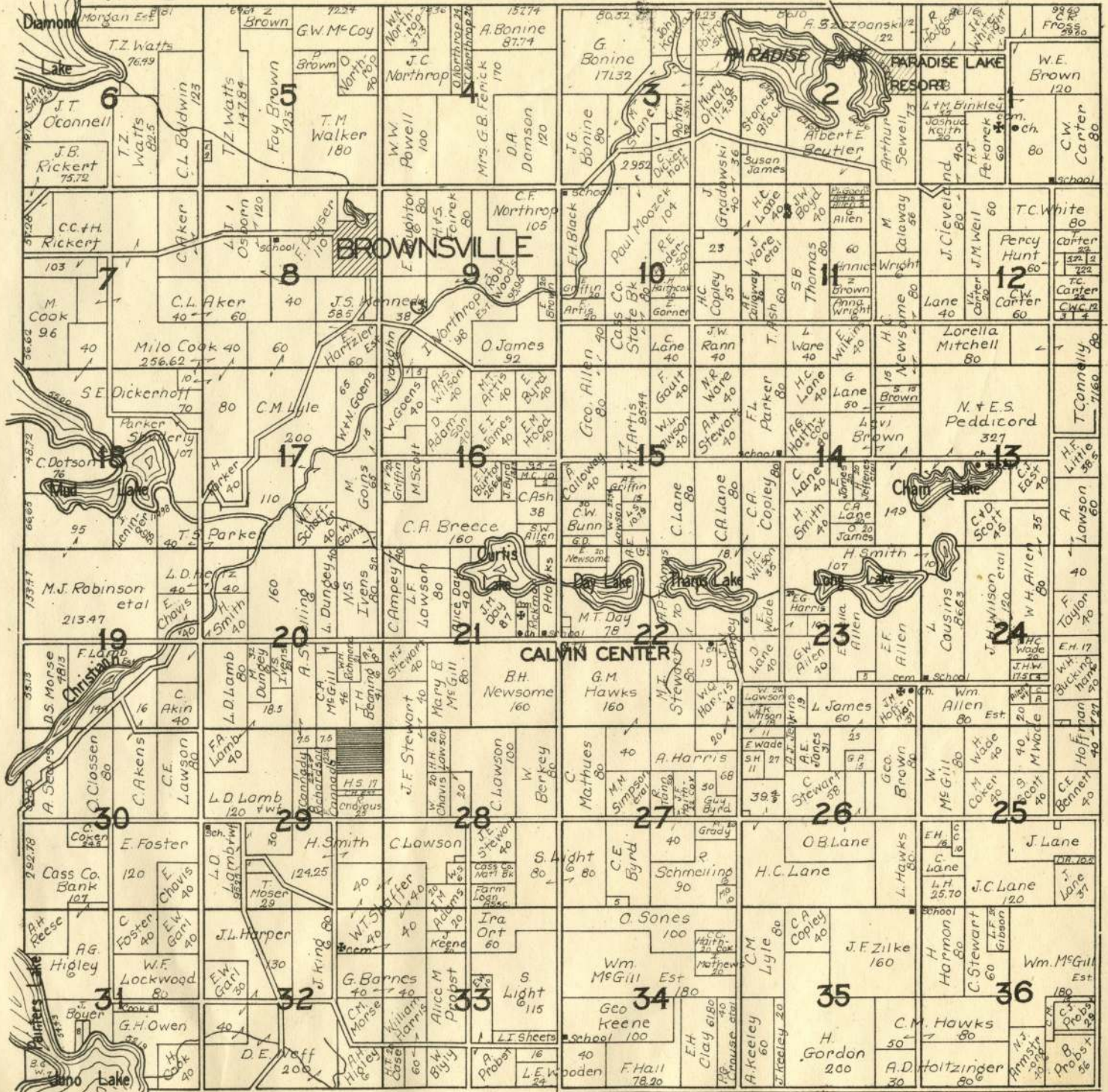

T.5S.

VOLINIA

R.14W.

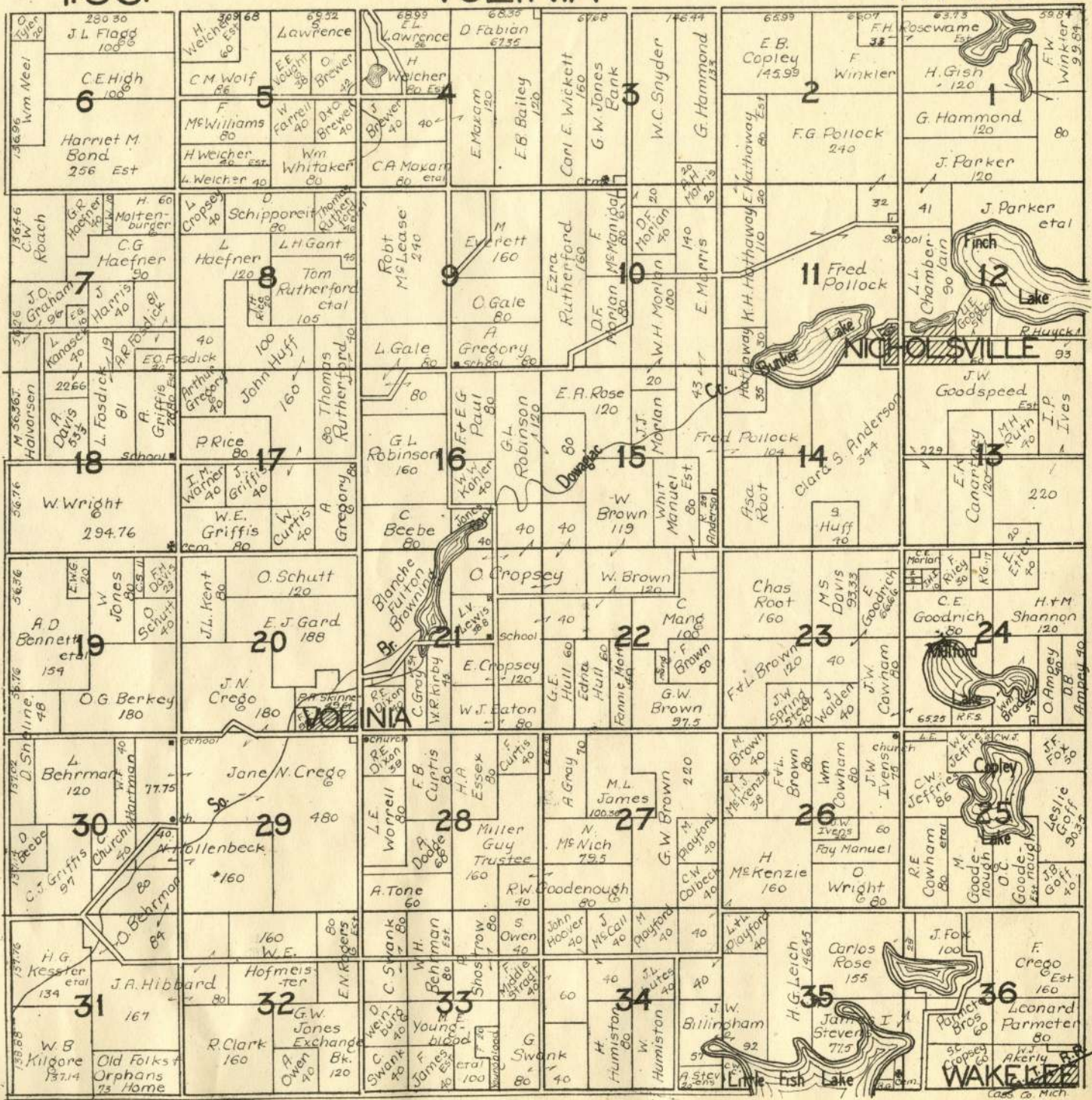

T.8S.

ONTWA

R.15W.

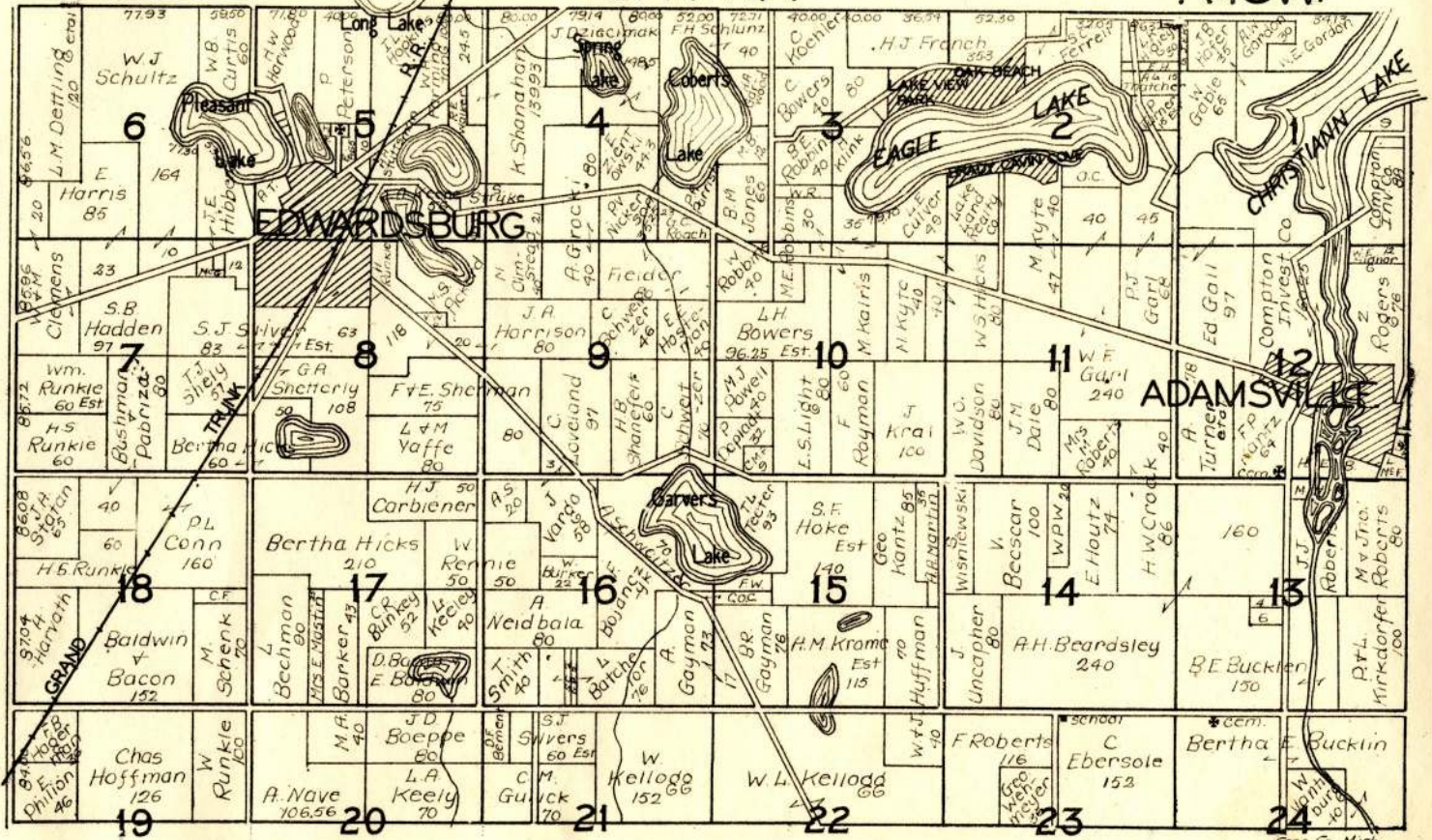

Cass Co. Mich.

T.7S.

JEFFERSON

R.15W.

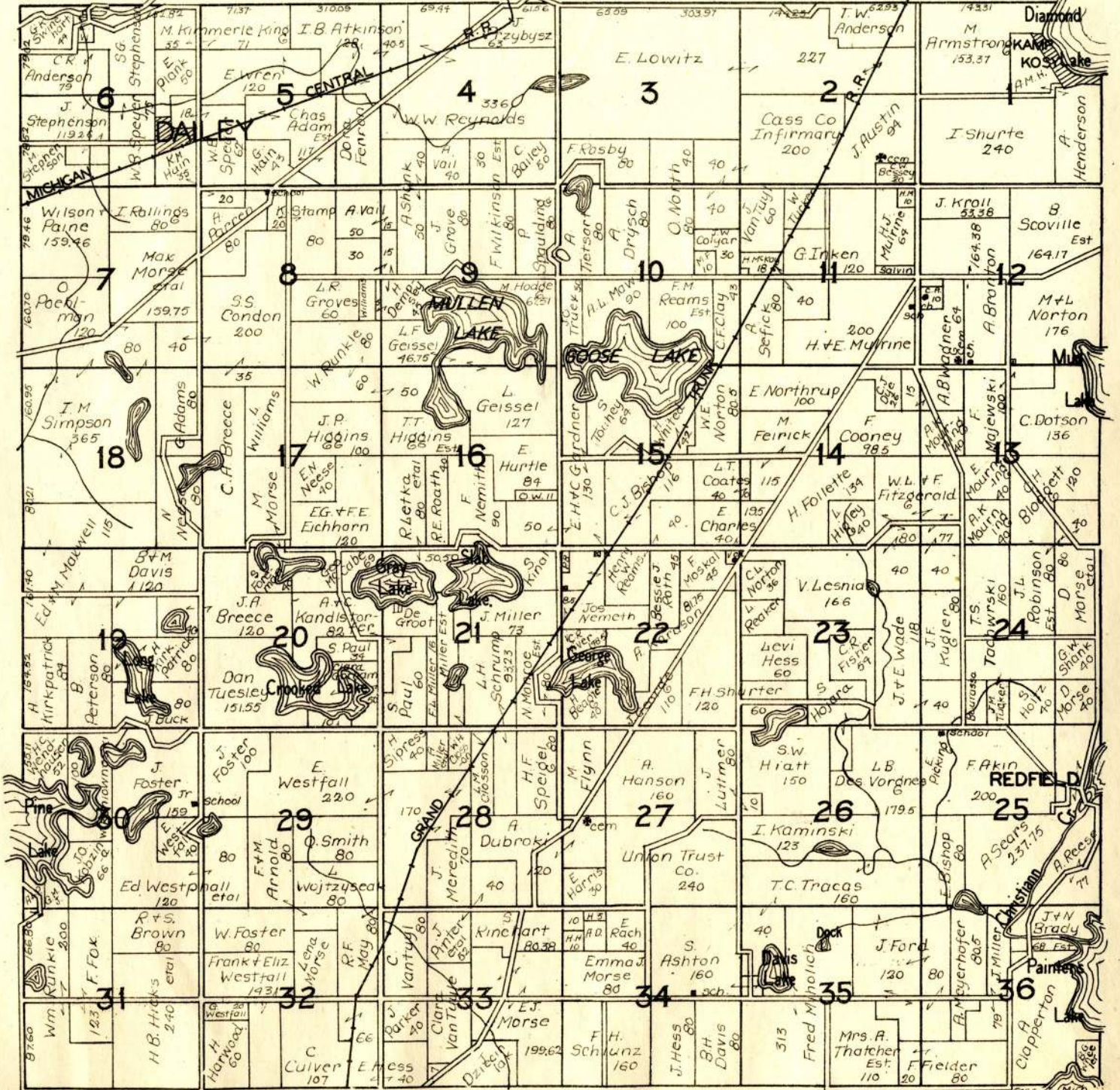

T. 6S

LA GRANGE

R. 15W.

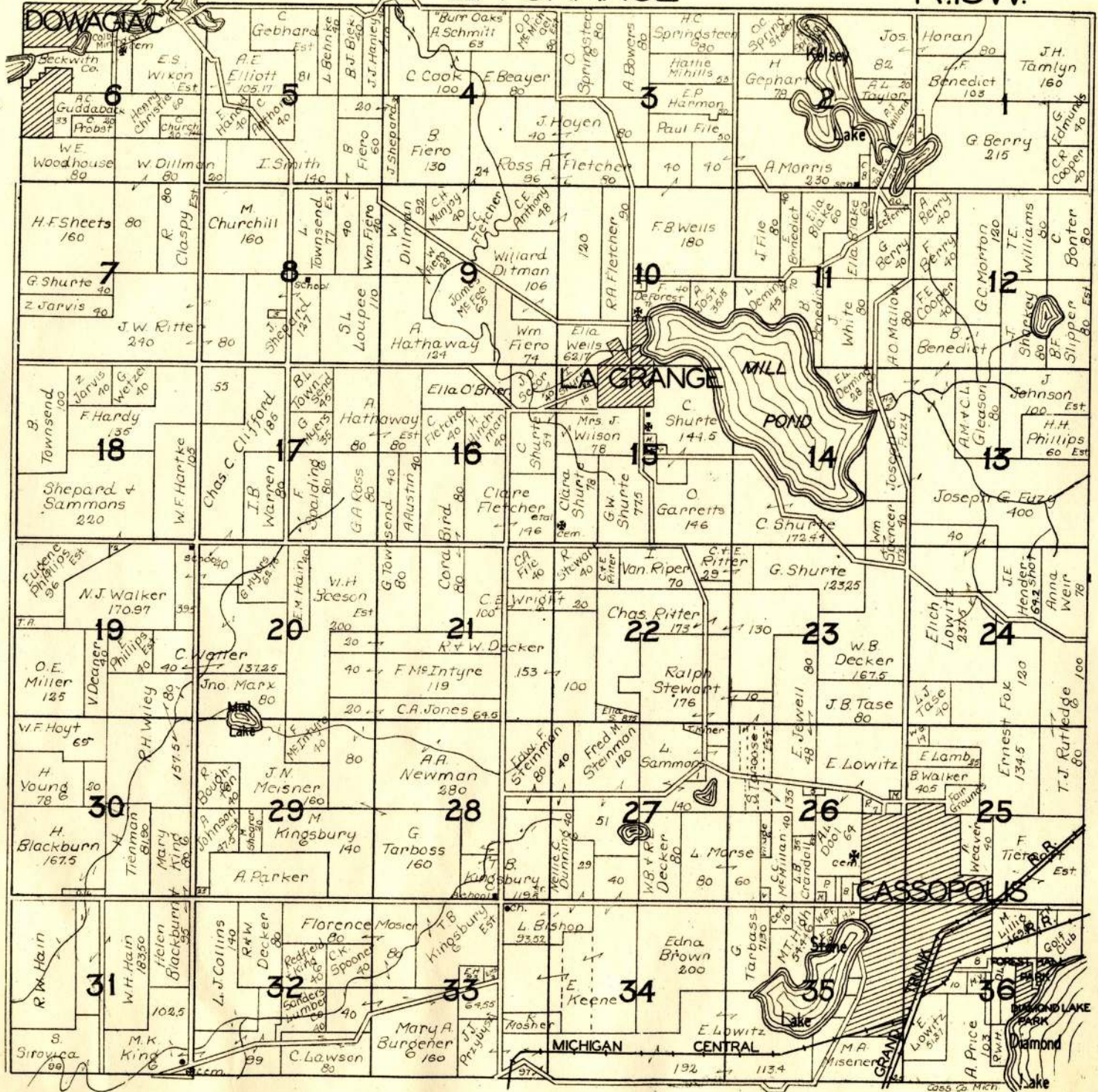

T. 5S.

WAYNE

R. 15W.

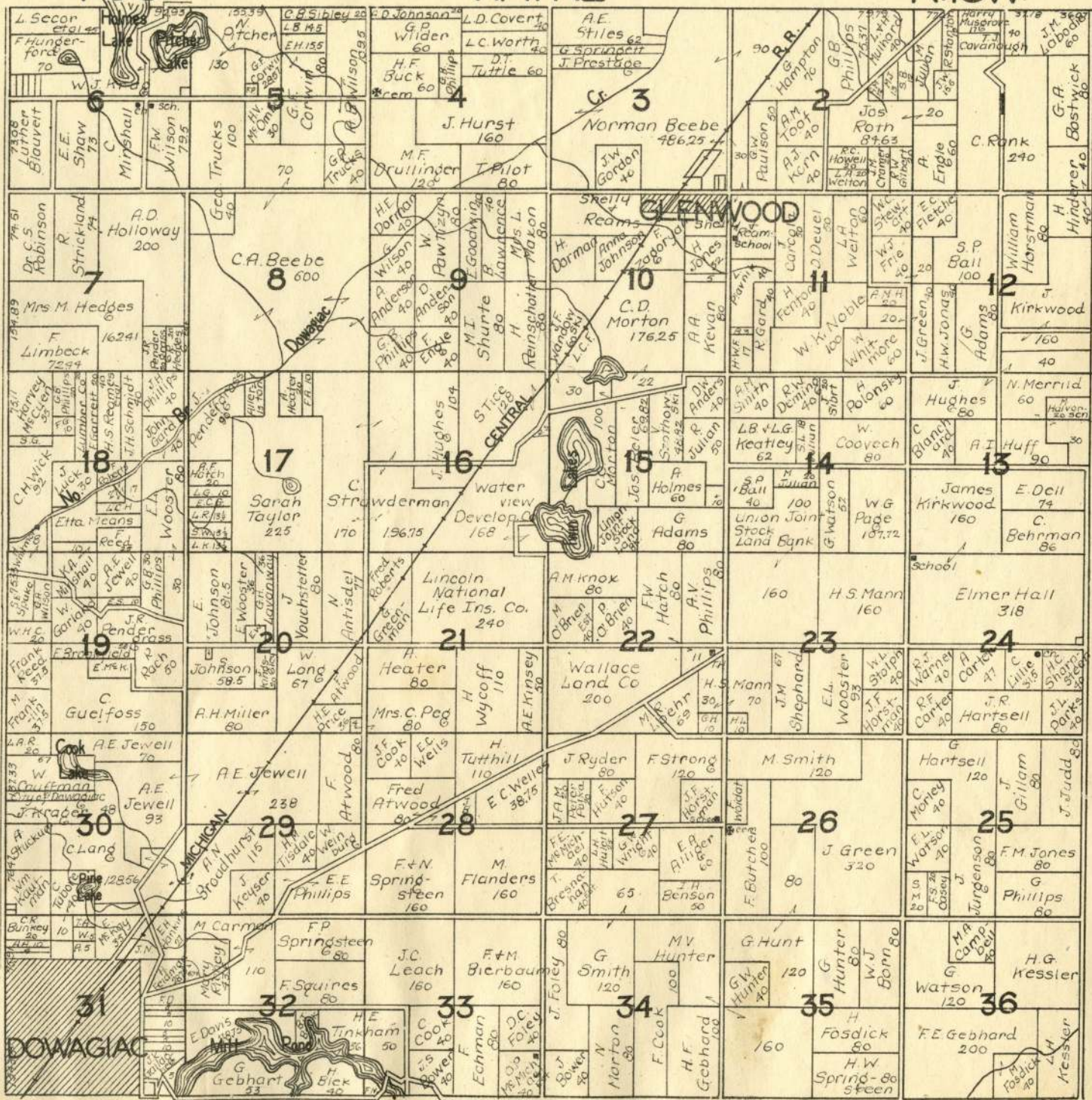

T. 8S.

MILTON

R. 16W.

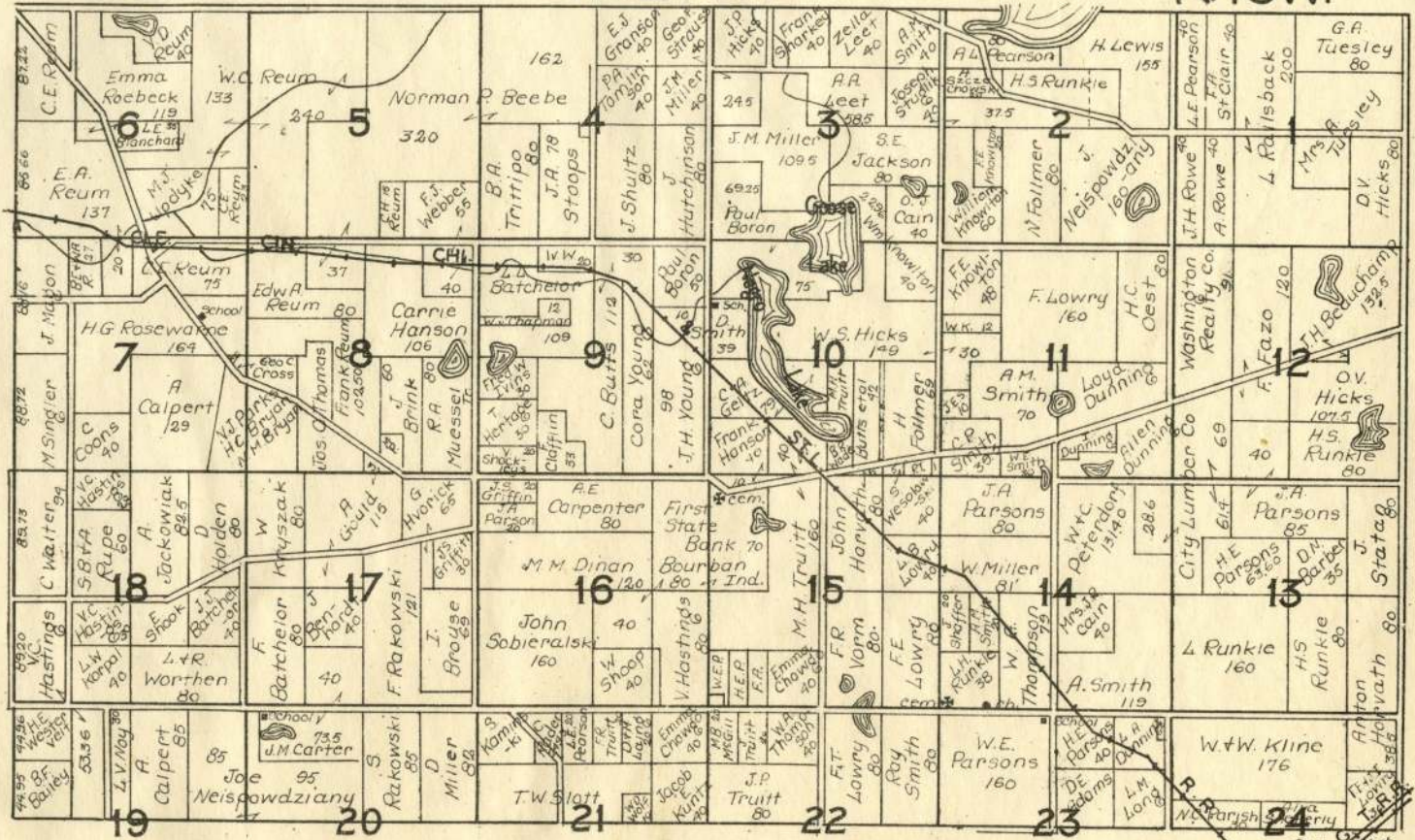

T.7S.

HOWARD

R.16W.

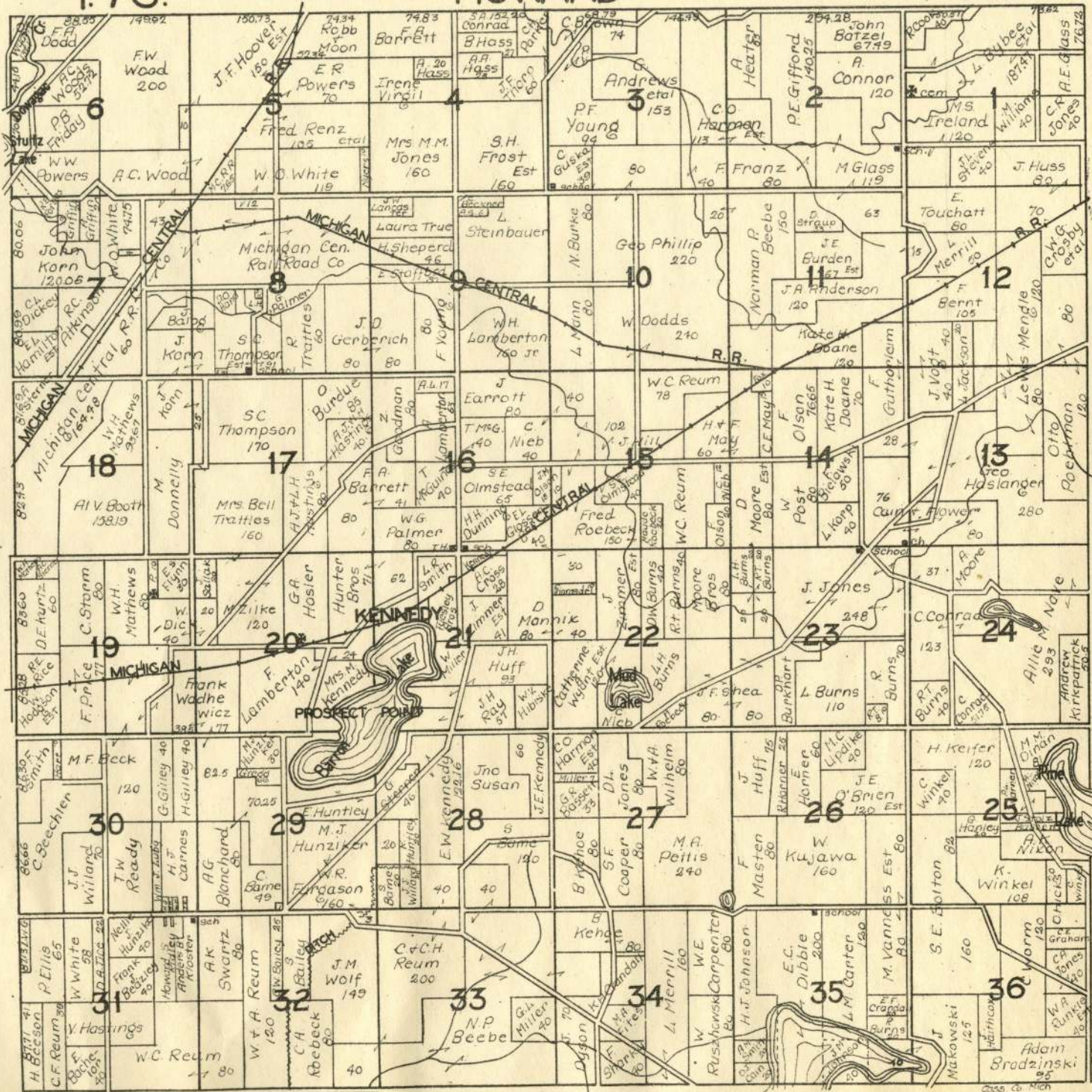

T.6S.

POKAGON

R.16W.

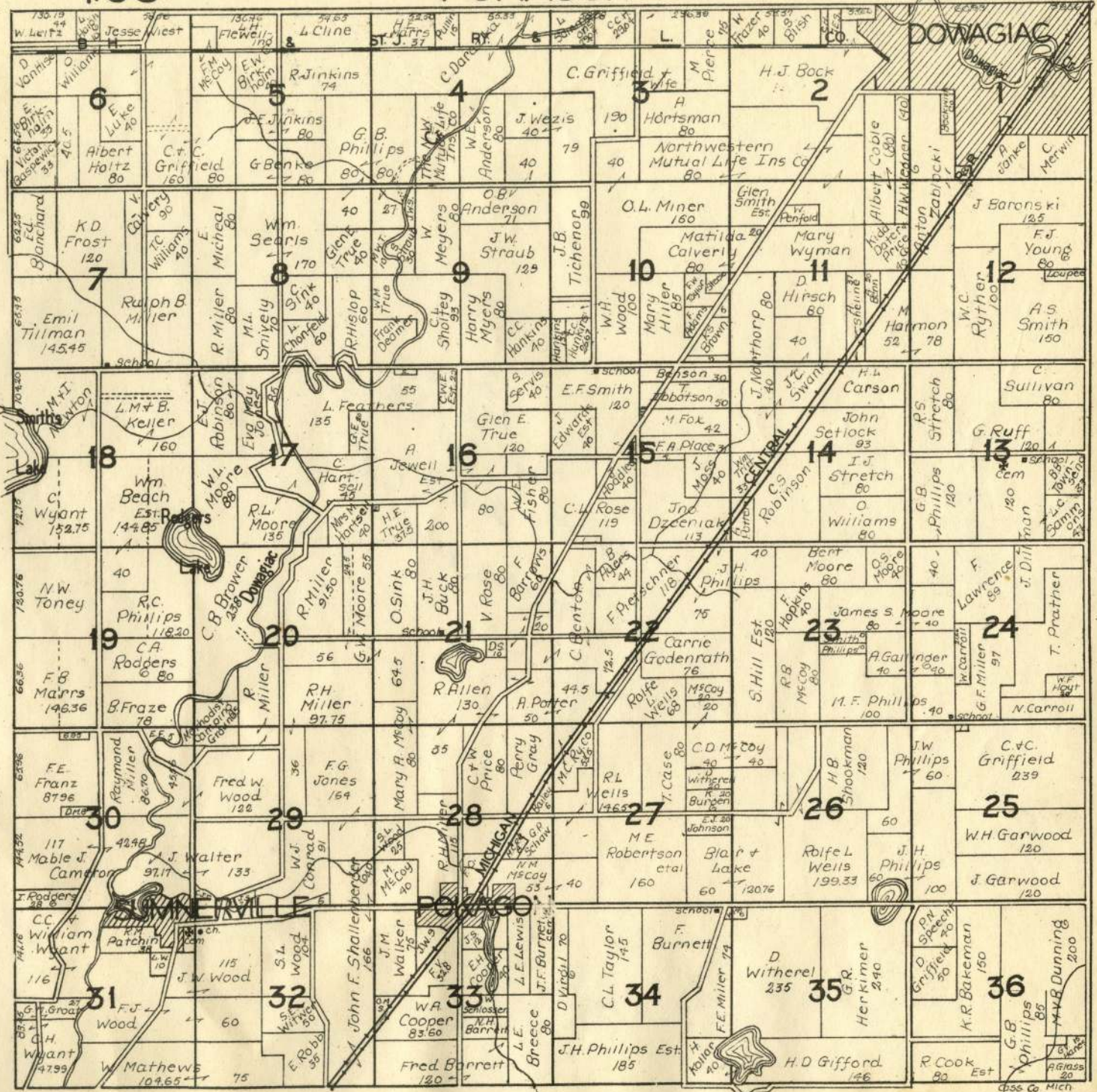

Cass Co Mich

T.5S.

SILVER CREEK

R.16W.

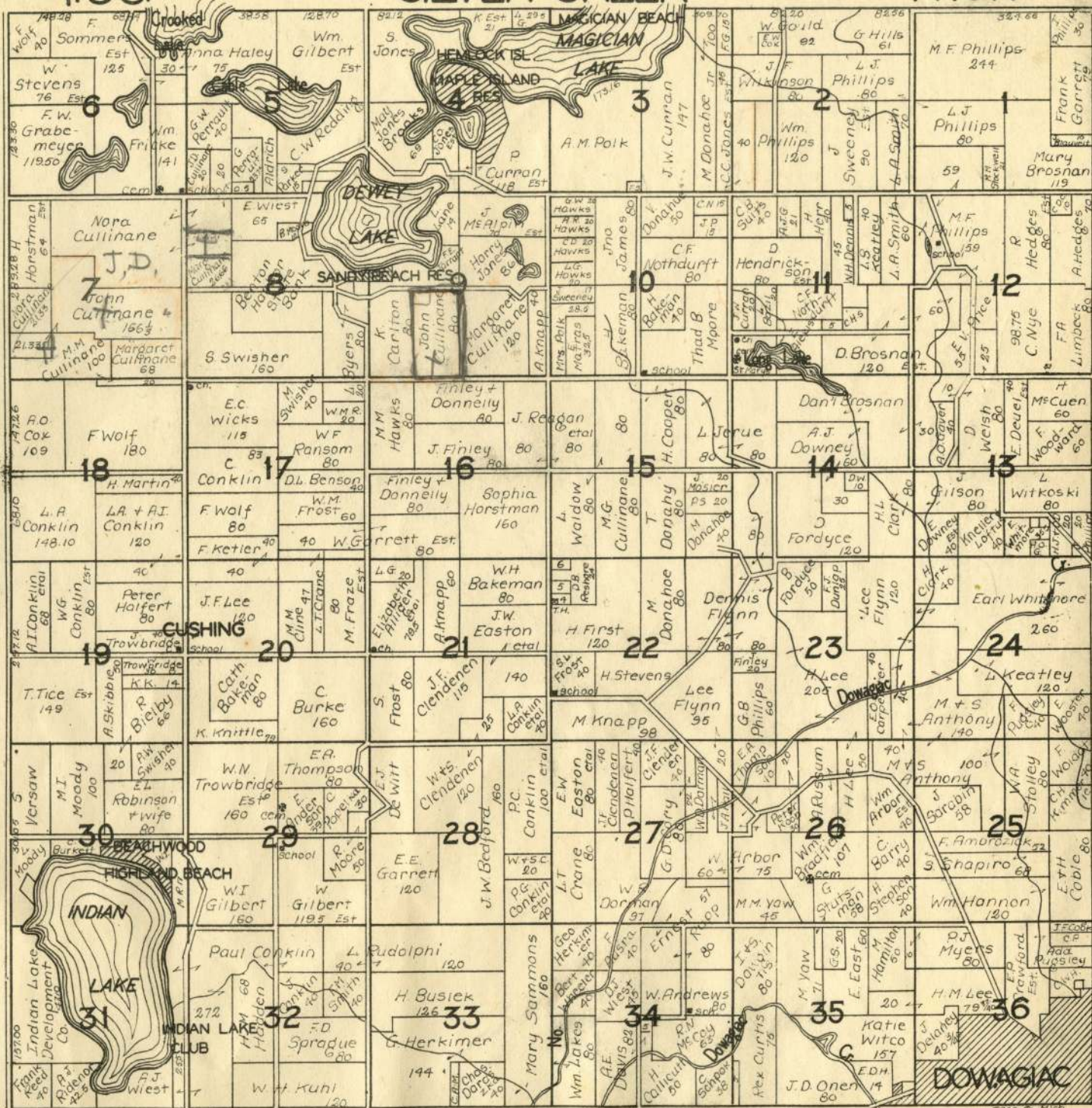

MICHIGAN STATE UNIVERSITY
MAP LIBRARY
ROOM USE ONLY